

Front

USER GUIDE
UPM64 paper
bright white



AURORA 12" RGB COLOR RING LIGHT



QUICK GUIDE

Item No.
DP-VRK12RGB

English

SPECIFICATION:

Input: USB 5V/2A (10 Watts)
RGB colors: 15
Special effect modes: 17
Color temperature settings: 3
Color temperature range: 2700-6000K
Brightness settings:
RGB - 10 levels
White light - 10 levels
Lumens 500-700LM
LEDs: 208
Stand height 63" (160cm)
Material: plastic, metal

PACKAGE INCLUDES

1. 12" ring light with 195cm cable and control pad
2. Extendable stand
3. Phone holder stand
4. Tripod head
5. Phone holder
6. Bluetooth remote
7. RF wireless remote

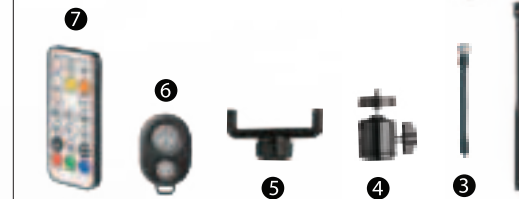

English

INSTALLATION:



1. Attach the phone holder to the phone holder stand
2. Attach the phone holder stand to the ring light
3. Attach the tripod head to the bottom of the ring light
4. Attach the tripod to the bottom of the tripod head
5. Extend the tripod legs and turn the locking knob to secure it

FULL SET

English

BLUETOOTH REMOTE

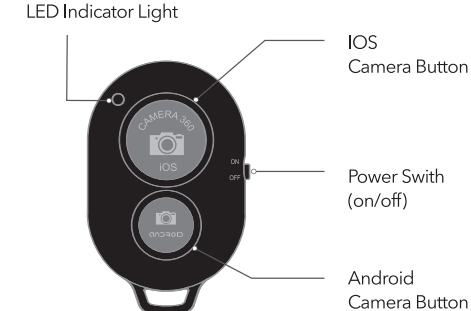

PAIRING THE BLUETOOTH REMOTE

1. When you turn the remote on, it will automatically enter pairing mode, the LED indicator light will begin to flash blue repeatedly.
2. Once in pairing mode, open the settings menu on your smartphone, keep the device and the remote within 3 meters (10 feet) of each other.
3. Enable Bluetooth pairing and wait for your device to locate the shutter remote.
4. When this happens, "GO VIRAL" will appear on the device list, select this option, follow the prompt to pair the remote.
5. The LED indicator light will turn off after a successful connection.

SPECIFICATIONS

1. Wireless remote: Bluetooth v4.2
2. Operating frequency: 2.402GHz - 2.480GHz
3. Wireless range: 10M (33ft)

CHANGING THE BATTERY ON THE BLUETOOTH REMOTE

1. Slide the door open
2. Replace the battery with a coin cell CR2032
3. The battery printing should be facing up
4. Slide the door closed and lock it

English

RF WIRELESS REMOTE

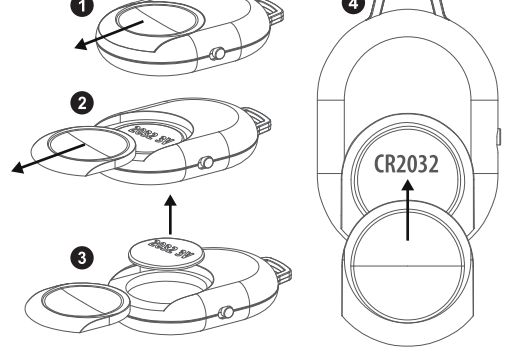

OPERATING THE LAMP WITH RF WIRELESS REMOTE CONTROL

1. The remote control contains a CR2025 3V lithium battery
- Recommended battery: CR2025 3V lithium
- To replace the battery follow the instructions on the back of the remote control
- Modes will display in the same order as described above when controlling the lamp with USB cable control button

1. Press Auto (AUTO) button to display all the available modes in order one by one.
2. Use the buttons (M+) (M-) to change modes.
3. Use the buttons (S+) (S-) to slow or speed up the modes.
4. Lock button (LOCK) Works with the following modes: White, Warm, Neutral, Red, Green, Blue and RGB.

- After pressing this button, the lamp will lock the selected mode, unabling to change the color, mode, dim and brighten or turning off. In order to unlock the lamp, press the lock button again.

English

USING THE LIGHT



NOTE: When you power off the light it will remember your last settings.

English

WARRANTY

Questions? Problems? Picked up the wrong item? Before returning to the Store, please give our customer service team a chance to help. Email us at TechSupport@Mizco.com Mizco International, Inc. Cranford, New Jersey 07016 All rights reserved. DIGIPOWER is a registered trademark of Mizco International Inc.

WARRANTY INFORMATION FOR DIGIPOWER PRODUCTS, A DIVISION OF MIZCO INTERNATIONAL, INC.

We warrant all DigiPower branded products against defects in material and workmanship for one year from the original date of purchase. At our option, we shall repair or replace the defective unit covered by this warranty. Please retain the dated sales receipt as evidence of the date of purchase in order to obtain any warranty service. This warranty is void if the product has been handled or used in any manner which is inconsistent with the instructions accompanying the product or the intended use of the product. This warranty does not cover any damage due to accident, misuse, abuse, or negligence. This warranty does not extend to equipment used with the product. This warranty is valid only if the product is used on a compatible device as specified on or attached to the product package. To verify compatibility, please check the product package for details or visit: www.DigiPowerSolutions.com. Repair or replacement, as provided under this warranty, is your exclusive remedy. We shall not be liable for any incidental or consequential damages. DigiPower hereby expressly disclaims any and all implied warranties of merchantability and fitness for a particular purpose. Some states/countries do not allow the exclusion or limitation of incidental or consequential damages, so the above limitation or exclusion may not apply to you. Some states/countries do not allow limitations on implied warranties, so the above limitation may not apply to you. This warranty gives you specific legal rights, and you may also have other rights that vary from state to state and country to country.

FCC STATEMENT:

This equipment has been tested and found to comply with the limits for a Class B device, pursuant to Part 15 of the FCC Rules. These limits are designed to provide reasonable protection against harmful interference in a residential installation. This equipment generates uses and can radiate radio frequency energy and, if not installed and used in accordance with the instructions, may cause harmful interference to radio communications. However, there is no guarantee that interference will not occur in a particular installation. If this equipment does cause harmful interference to radio or television reception, which can be determined by turning the equipment off and on, the user is encouraged to try to correct the interference by one or more of the following measures:

- Reorient or relocate the receiving antenna.
- Increase the separation between the equipment and receiver.
- Connect the equipment into an outlet on a circuit different from that to which the receiver is connected.
- Consult the dealer or an experienced radio/ TV technician for help.

ADJUSTING THE COLOR TEMPERATURE (THIS FUNCTION ONLY WORKS FOR THE WHITE LIGHT)

- Press the (C) button to change the color temperature of the light from cool to daylight to warm.
- Each press of the (A) or (V) button will adjust the light brightness

English

WARRANTY

IC CAN IEC5-003/NMB-003
BT remote FCC ID:RZOGOVIRAL IC:9712A-GOVIRAL
RF remote FCC ID:RZO-RFREMOTE

