

AP200 Wireless Access Point

Quick Installation Guide

Introduction

This guide is to assist the reader with the most basic form of installation and connection to this access point.

Package Contents

After purchasing the access point, the following items will be included in the package:

- One AP200 Wireless Access Point.
- One Quick Installation Guide.
- One power supply adapter.
- One rack/wall-mount back plate.
- Two Phillips-head screws with anchor plugs.

Note: If any of the above mention items was not found inside the package contents of this access point or are damaged in any way, contact your reseller immediately.

Hardware Installation

Installation Guidelines

This section will discuss the hardware installation guidelines that administrators must follow in order to properly and safely install this access point into the appropriate environment.

Installation onto the Ceiling

The following steps explain how to successfully install this access point onto the ceiling.

1. Drill two holes into the ceiling and insert the screw anchor plugs provided into the holes.

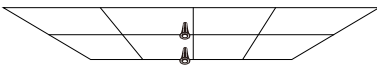

2. Position the mounting back plate over the holes and then fasten the back plate to the ceiling using the two Phillips-head screws provided.

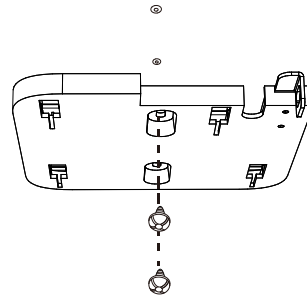

3. Position the access point over the mounting back plate and align the slider pegs into the slider peg holes. Carefully slide the access point downwards until the access point stops into position.

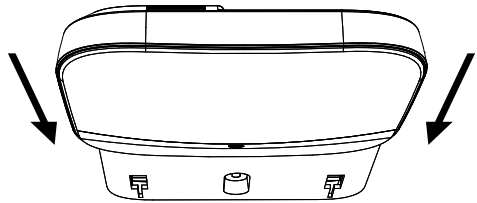

Additionally a security lock can be used to secure the access point onto the mounting site.

Installation onto the Wall

The following steps explain how to successfully install this access point onto a wall.

1. Drill two holes into the wall and insert the screw anchor plugs provided into the holes.

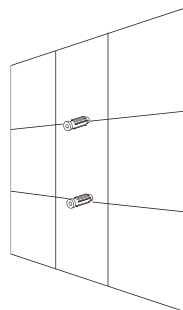

2. Position the mounting back plate over the holes and then fasten the back plate to the wall using the two Phillips-head screws provided.

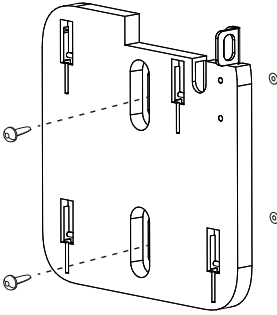

3. Position the access point over the mounting back plate and align the slider pegs into the slider peg holes. Carefully slide the access point downwards until the access point stops into position.

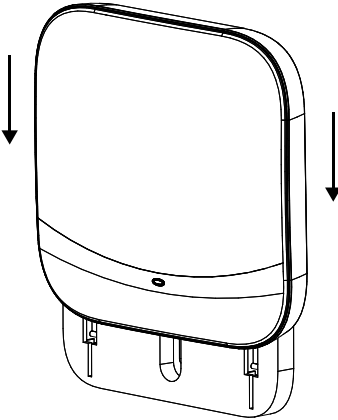

Additionally a security lock can be used to secure the access point onto the mounting site.

Connect the Power Supply

The following steps explain how to successfully connect the power supply to the access point.

1. Connect the one end of the power supply cable, included in the package, into the grounded electrical outlet at the site.
2. Insert the other end of the power supply cable into the power receptacle on the back panel of the access point.

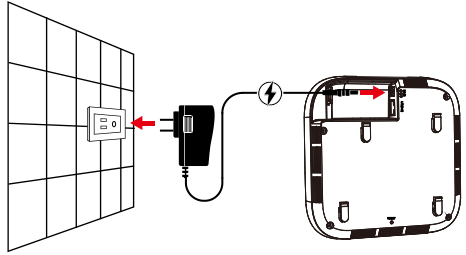

The LED indicator on the front panel of the access point should come on.

Connect the Ethernet Cable

The following steps explain how to successfully connect the non-PoE Ethernet cable to the access point.

1. Connect the one end of the Ethernet cable, included in the package, into the Ethernet port of the Management PC or Ethernet switch/router.
2. Insert the other end of the Ethernet cable into the LAN port on the back panel of the access point.

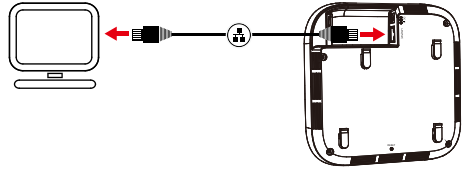

Connect the PoE Ethernet Cable

The Ethernet port of this access point supports the IEEE 802.3af Power-over-Ethernet (PoE) standard. When a power source for the traditional power supply is not available close to the access point, power can be supplied to the access point through the Gigabit Ethernet port using PoE.

The following steps explain how to successfully connect a PoE Ethernet cable to the access point.

1. Connect the one end of the PoE Ethernet cable into the power supplying PoE Ethernet port of the PoE source device.
2. Insert the other end of the PoE Ethernet cable into the LAN port on the back panel of the access point.

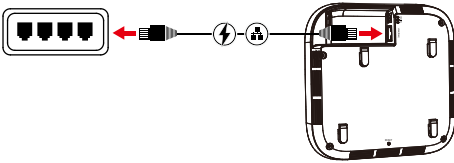

The LED indicator on the front panel of the access point should come on.

Software Connection

The default IP address of the access point is **192.168.0.50** with a subnet mask of **255.255.255.0**. By default, the username is **admin** and there is no password.

Connect to the Web User Interface

On the management PC, open any standard web browser software, like Internet Explorer and in the address bar enter the IP address of the access point. Press the **Enter** key the keyboard.

The login window will appear as shown below:



Enter the username and password, in the spaces provided, and click the **Login** button to access the Web UI.

For more information about the Web User Interface configuration, refer to the *AP200 User Guide*.

Other Software Connections

This access point can be managed by the WiFi Controller software, greatly enhancing manageability and wireless frequency optimization as well as providing additional user management and security options. For more information about the WiFi Controller software, refer to the *AP200 User Guide*.

Safety Instructions

The following sections provide safety precautions to follow when installing the access point.

Safety Precautions

- For your protection, observe the following safety precautions when setting up your equipment:
- Follow all cautions and instructions marked on the equipment.
 - Only trained and qualified personnel are allowed to install or to replace this equipment.
 - Never push objects of any kind through openings in the equipment. Dangerous voltages may be present. Conductive foreign objects could produce a short circuit that could cause fire, electric shock, or damage to your equipment.
 - This product is intended for restricted access whereby access is controlled through the use of a means of security (for example, key, lock, tool, badge access) and personnel authorized for access have been instructed on the reasons for the restrictions and any precautions that need to be taken.
 - Remove all metal jewelry, such as rings and watches, before installing or removing the device.
 - Do not install in direct sunlight, or a damp or dusty place.
 - Do not expose the device to moisture or water.
 - Disconnect all power supply cords before servicing.

Electrical Safety Precautions

- For your protection, observe the following electrical safety precautions when setting up your equipment:
- Ensure that the voltage and frequency of your power source match the voltage and frequency inscribed on the equipment's electrical rating label.
 - Not all power cords have the same current ratings. Do not use the power cord provided with your equipment for any other products or use. Household extension cords do not have overload protection and are not meant for use with this product. Do not use household extension cords with this product.
 - To prevent electric shock, do not remove the cover of this product. There are no user-serviceable parts inside. This unit contains hazardous voltages and should only be opened by a trained and qualified technician.
 - Do not work on equipment or cables during periods of lightning activity.
 - Check to see if there are any exposed copper strands coming from the installed wire. When this installation is done correctly there should be no exposed copper wire strands extending from the terminal block. Any exposed wiring can conduct harmful levels of electricity to persons touching the wires.
 - When using the power supply, the power source for the device should be located near the unit and should be easily accessible.

- **Circuit Overloading:** Consideration should be given to the connection of the equipment to the supply circuit and the effect that overloading of circuits might have on overcurrent protection and supply wiring. Appropriate consideration of equipment nameplate ratings should be used when addressing this concern.

Installation Safety Precautions

For your protection, observe the following installation safety precautions when setting up your equipment:

- **Elevated Operating Ambient** - If installed in a closed ceiling, the operating ambient temperature of the ceiling environment may be greater than room ambient. Therefore, consideration should be given to installing the equipment in an environment compatible with the maximum ambient temperature (T_{ma}) specified by the manufacturer.
- **Reduced Air Flow** - Installation of the equipment in a ceiling should be such that the amount of air flow required for safe operation of the equipment is not compromised.
- **Circuit Overloading** - Consideration should be given to the connection of the equipment to the supply circuit and the effect that overloading of the circuits might have on overcurrent protection and supply wiring. Appropriate consideration of equipment nameplate ratings should be used when addressing this concern.
- The mounting brackets provided must be used to securely mount the device.

Regulations & Warnings

FCC Warning

This equipment has been tested and found to comply with the limits for a Class B digital device, pursuant to Part 15 of the FCC Rules. These limits are designed to provide reasonable protection against harmful interference in a residential installation. This equipment generates, uses and can radiate radio frequency energy and, if not installed and used in accordance with the instructions, may cause harmful interference to radio communications. However, there is no guarantee that interference will not occur in a particular installation.

If this equipment does cause harmful interference to radio or television reception, which can be determined by turning the equipment off and on, the user is encouraged to try to correct the interference by one of the following measures:

- Reorient or relocate the receiving antenna.
- Increase the separation between the equipment and receiver.

- Connect the equipment into an outlet on a circuit different from that to which the receiver is connected.
- Consult the dealer or an experienced radio/TV technician for help.

This device complies with Part 15 of the FCC Rules.

Operation is subject to the following two conditions: (1) This device may not cause harmful interference, and (2) this device must accept any interference received, including interference that may cause undesired operation.

Any changes or modifications not expressly approved by the party responsible for compliance could void the user's authority to operate this equipment.

For product available in the USA/Canada market, only channel 1~11 can be operated. Selection of other channels is not possible.

This device and its antenna(s) must not be co-located or operating in conjunction with any other antenna or transmitter except in accordance with FCC multi-transmitter product procedures.

This device is going to be operated in the 5.15~5.25GHz frequency range. It is restricted in indoor environment only.

IMPORTANT NOTE:

FCC Radiation Exposure Statement:

This equipment complies with FCC radiation exposure limits set forth for an uncontrolled environment. This equipment should be installed and operated with a minimum distance of 20cm between the radiator and your body.

Warranty

This product supports a 2 year warranty.

GNU General Public License (GPL)

Firmware incorporated into this product may include third party copyrighted software licensed under the General Public License (GPL) or Lesser General Public License (LGPL), collectively known as GPL software and not Canary Networks' End User License Agreement.

In accordance with the GPL, if applicable:

1. The source code for the GPL software may be downloaded at no charge from the following website: <website needed>.
2. The GPL software used may be modified, reused, and redistributed.
3. With respect solely to the GPL software, no warranty is provided, to the extent permitted by applicable law.

4. A copy of the GPL is included herewith, may be obtained at <http://www.gnu.org>, and may also be found at <http://www.canarynetworks.com/support>.

Modification of or tampering with the software of this device, including but not limited to any Open Source Software, is solely at your own risk. Canary Networks is not responsible for any such modification or tampering. Canary Networks will not support any product in which you have or have attempted to modify the software supplied by Canary Networks.

Service and Support

For service and support information phone us at +1-847-468-1840 or email us at support@canarynetworks.com.

For More Information

For more information, please visit <http://www.canarynetworks.com>.