



powerstation® go wireless

OPERATING INSTRUCTIONS



mophie powerstation go wireless

Thank you for choosing mophie!

Powerful, compact and easy to use, the mophie powerstation go wireless can safely jump start your car. In addition, you can use it to charge your phone, tablet or other electronic devices. Equipped with wireless charging to charge compatible smartphones, the mophie powerstation go wireless also features a convenient LED floodlight.

Safety precautions

DANGER-CAUTION Read and understand all safety information before using this product. Failure to follow these instructions may result in electrical shock, explosion, fire which may result in serious injuries, death and property damage.

- When used correctly, lithium-ion rechargeable batteries provide a safe and dependable source of portable power. However, if they are misused or abused, this may result in leakage, burns, fire or explosion, causing personal injury or damage to other devices.
- Misusing or incorrectly connecting your mophie powerstation go wireless may cause electric shock to users and damage equipment.
- Do not operate in explosive atmospheres such as in the presence of flammable liquids, gases or dust.
- Remove jump start clamps from vehicle battery after jump starting vehicle.
- Keep your mophie powerstation go wireless dry and away from moisture and corrosive materials. The mophie powerstation go air should not be used near water or wet areas such as bathtubs, showers, bathrooms, sinks, swimming pools or basements.
- Do not expose your mophie powerstation go wireless to moisture, water, rain, or snow.
- Keep your mophie powerstation go air away from heat sources, including open flames, radiators, stoves, ovens, and any other devices that produce heat.
- The lithium-ion rechargeable battery used in this charging device may present a risk of fire or chemical burn if mistreated. Do not expose to fire or excessive temperature. Do not expose to heat above 212°F (100°C) or incinerate.

- In the unlikely event of leakage or explosion use sand or a chemical fire extinguisher.
- Your mophie powerstation go wireless may become warm under extended high power operation. Do not cover, wrap, or otherwise restrict the mophie powerstation go air during operation.
- Do not disassemble your mophie powerstation go wireless. There are no user-serviceable parts inside. Incorrect reassembly may result in shock or fire hazard.
- Do not drop or subject to strong impacts. Do not operate your mophie powerstation go air if it has received a sharp blow, or has otherwise been damaged in any way.
- Do not puncture, crush or subject to mechanical shock.
- Only charge your mophie powerstation go wireless by the specified method with the specified charging adapter provided with the unit.
- Do not use any non-mophie-branded accessories with the mophie powerstation go air. Doing so may cause electric shock to users and damage equipment.
- The mophie powerstation go wireless, along with its accessories, are not toys and should be kept away from children.
- Make sure the jumper cables are fully plugged into the jump start output before trying to jumpstart your vehicle.
- Do not touch red (positive) and black (negative) jumper clamps together at any point.
- Do not insert any foreign object into the ports or openings of your mophie powerstation go wireless.

- Do not clean your mophie powerstation go wireless with harsh chemicals, soaps or detergents. Just wipe the case with a soft cloth.
- Make sure the mophie powerstation go wireless charging ports do not become contaminated with lint or other debris. Use a canned-air type of product periodically to ensure that the port openings are clear.
- When using the air compressor, always check and follow the manufacturer's recommended pressure. Use caution as the air hose and connectors may get hot after extended use.
- Batteries should be recycled or disposed of as per state and local guidelines.
- Storage: -4°F - 131°F (-20°C - 55°C), Discharge: 14°F - 122°F (-10°C - 50°C), Charge: 32°F - 113°F (0°C - 45°C)

Table of contents

1		Safety Precautions
6		Included Items
8		Operating Instructions
19		Specifications
20		Warranty Information

Included items

- mophie psg wireless
- Jumper Cables
- 14V Charging Adapter
- Car Charger
- Carrying Pouch

Location of controls

- 1 | Wireless-Charging Pad
- 2 | Jump-Start Output
- 3 | Jump-Start Button
- 4 | Digital Screen
- 5 | Device Kickstand
- 6 | USB/Wireless-Charging ON/OFF Button
- 7 | USB Outputs 1 & 2
- 8 | LED Floodlight
- 9 | LED Floodlight Button
- 10 | Positive Clamp (red)
- 11 | Negative Clamp (black)
- 12 | Jump-Start Plug
- 13 | Car Charger
- 14 | 14V Charging Adapter
- 15 | 14V Charge Input

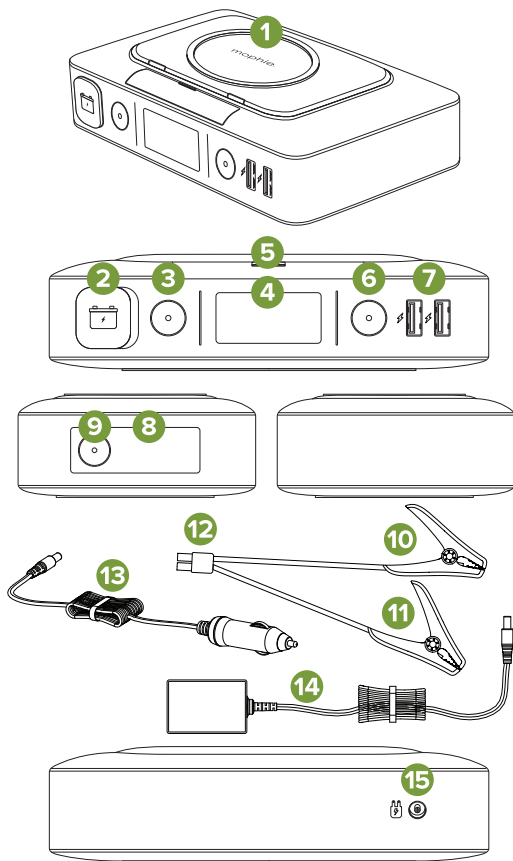

Operating instructions

Please make sure your powerstation go wireless is fully charged before use.

Charging the powerstation go wireless

To charge the powerstation go wireless, use the provided AC charging wall adapter, and plug the AC adapter tip into the powerstation go wireless charge input.

Next, connect the AC adapter into a wall outlet. The powerstation go wireless will automatically begin charging. When the powerstation go wireless is fully charged, all five indicator lights will be solid white (this could take up to 9 hours).

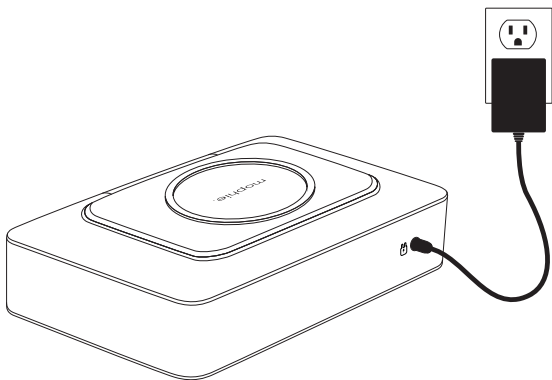

While charging, the digital screen will illustrate the charge percentage of the powerstation go wireless. When fully charged, disconnect the cable.

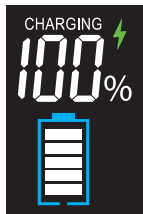

NOTE: The powerstation go wireless is designed to charge between 32°F-113°F (0-45° C). A "TEMP" indicator will be illustrated on the digital display if the powerstation go wireless is attempted to be charged outside of this temperature range.

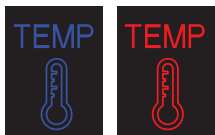

When you're on the road, you can also use the supplied Car Charger to charge your powerstation go wireless.

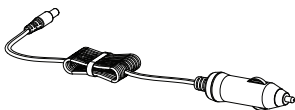

Jump starting your vehicle with the powerstation go wireless

1. Plug the jumper cables into the jump-start output on the powerstation go wireless.

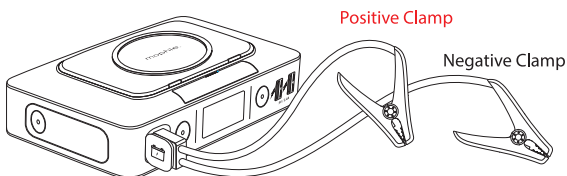

NOTE: Make sure the jumper cables are fully plugged into the jump-start output before trying to jump your vehicle.

2. Attach the jumper-cable clamps to the vehicle battery.

- Red clamp on positive terminal (+)
- Black clamp on negative terminal (-)

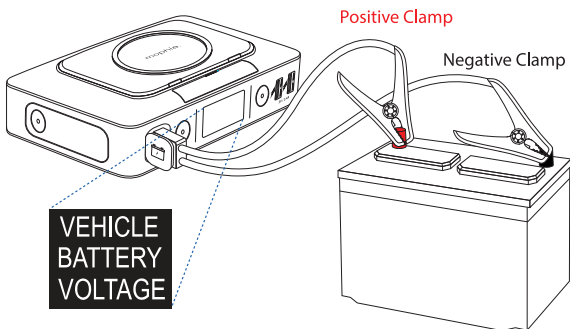

NOTE: Do not touch red (positive) and black (negative) clamps together at any point. If the jump-start button flashes and the 'SAFETY CHECK FAIL' indicator is visible on the digital display screen, the jumper cables have been connected incorrectly. If this flashing red condition occurs, disconnect the jumper cables from the mophie powerstation go wireless and the vehicle battery and restart the process from Step 1.

3. Press the button and wait for a solid green light.

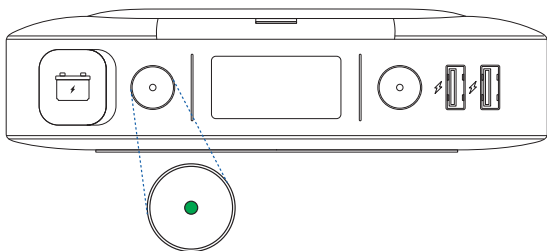

4. Start your vehicle.



NOTE: If your vehicle fails to start after the first attempt, wait 30 seconds and repeat step 3 and step 4.

If your vehicle does not start after three attempts, we recommend you consult a certified mechanic.

5. Disconnect the jumper-cable clamps from the car battery.

NOTE: The jump start function can not be used in conjunction with the USB or wireless charging pad. Please ensure that you have not activated the USB when attempting to jump start your vehicle.

Jump starting troubleshooting tips

Condition	Potential Cause	Solution
powerstation go wireless Jump Start button has been pressed but nothing happens	The USB ON/OFF Button or the AC Outlet ON/OFF Button has been pressed.	The jump start output can not be used in conjunction with the USB output or AC Outlet modes. Ensure that both USB and AC Outlet modes are off.
 powerstation go wireless displays a red "BATT TOO LOW" message	The powerstation go wireless is not sufficiently charged to jump start the vehicle.	Recharge the powerstation go wireless and verify at least 50% charged. Then try the jump start process again.
 powerstation go wireless Jump Start button flashes red and a SAFETY CHECK FAIL message is displayed	The jumper cables have not been properly connected to the vehicle battery.	Check the jumper cables and ensure that the red clamp is connected to the positive terminal (+) and the black clamp is connected to the negative terminal (-).
 powerstation go wireless Jump Start button flashes green continuously	The powerstation go wireless is waiting to be connected to a battery or a SAFETY CHECK FAIL has been triggered.	Check the jumper cables and ensure they are properly connected to the battery. Check and ensure the vehicle battery voltage is greater than 2.0V. If the SAFETY CHECK FAIL indicator is triggered during the jump start process, it is recommended that you consult with a certified mechanic.

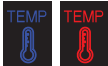
Condition	Potential Cause	Solution
 <p>powerstation go wireless displays a blue or red "TEMP" indicator</p>	<p>The powerstation go wireless has detected a low or high temperature</p>	<p>Disconnect the powerstation go wireless and allow unit to acclimate to temperature operating range (14°F-122°F).</p>
<p>You can not successfully jump start your vehicle. The powerstation go wireless displays a vehicle battery voltage greater than 12.0V</p>	<p>The powerstation go wireless detects that it is connected to a vehicle battery with a normal starting voltage. This could indicate that another vehicle component is faulty.</p>	<p>It is recommended that you consult with a certified mechanic.</p>
<p>powerstation go wireless Jump Start and On/Off button flashes red and blue</p>	<p>This could occur when attempting to jump start a vehicle while other electrical components (i.e. headlights, heater, radio, etc.) are on.</p>	<p>Turn off your headlights and any other components that may drain your car battery and try the jump start process again.</p>
	<p>The vehicle battery may be faulty.</p>	<p>It is recommended that you consult with a certified mechanic.</p>

Charging a compatible smartphone using wireless charging

1. First, make sure your smartphone is compatible with wireless charging.
2. Place your wireless-compatible device on top of the powerstation go wireless and press the USB/Wireless ON/OFF Button. Charging will begin.
3. Check your smartphone to confirm it is charging. If it is not charging, adjust the position of the phone on top of the powerstation go wireless.

NOTE: Ensure there is no metal obstruction on the back of the phone or phone case, or credit cards inside the phone case while wirelessly charging.

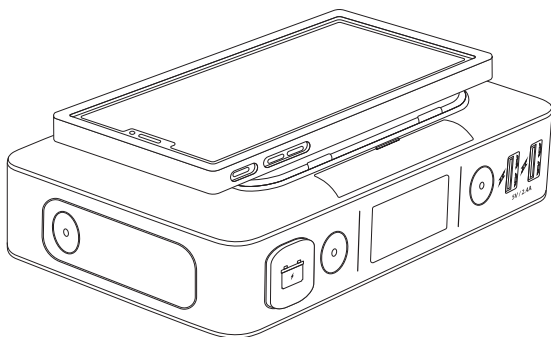

Wireless charging troubleshooting tips

Condition	Potential Cause	Solution
Smartphone does not charge when placed on the wireless charging pad.	Phone case may be too thick or other obstructions such as metal, magnets stickers, and rings may prevent wireless charging.	Remove any obstructions that are on the back of the phone.
	Phone is not compatible with wireless charging.	Confirm your smartphone is compatible with wireless charging.
	The wireless function is controlled via the USB and Wireless Charging ON/OFF Button.	Press the USB and Wireless Charging ON/OFF Button to activate wireless charging. The button will illuminate white.
	Mobile phone is not properly aligned and centered on top of the wireless charging pad.	Reposition mobile phone so that it is centered on the top of wireless the charging pad.

Charging an electronic device using the USB output ports

1. Using the USB cable that came with your phone or device, plug in the Standard USB connector into either one of the powerstation go wireless' two USB Output ports.
2. Turn on the USB charging feature by pressing and releasing the USB/Wireless ON/OFF Button on the powerstation go wireless.

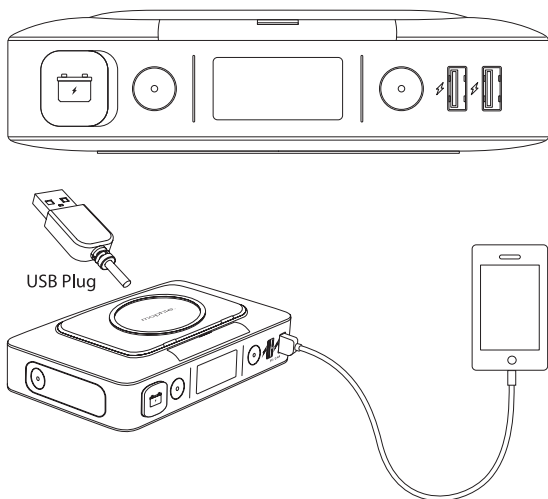

NOTE: The powerstation go wireless USB charging feature will automatically power off after 30 minutes of inactivity.

mophie smart charge technology

Your mophie powerstation go wireless contains mophie SMART CHARGE TECHNOLOGY to achieve greater compatibility for charging standard 5V USB electronic devices. mophie SMART CHARGE TECHNOLOGY will allow the powerstation go wireless charger to communicate with your electronic device and provide the fastest and safest charge for that device.

Compatibility

Standard 5V USB electronic devices including: mobile phones, tablets, PSP, NDS, MP3, MP4, MP5, Bluetooth, GPS, cameras, and more.



Tablets



Smartphones



Digital Camera



Headphones



Mobile Gaming



Wearables

+MORE

Using your powerstation go wireless floodlight

The floodlight can be turned on and off by simply pressing and releasing the floodlight ON/OFF button. The floodlight will automatically turn off after 2 hours of inactivity.

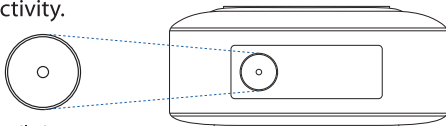

LED Floodlight ON/OFF Button

NOTE: Do not look directly into the LED floodlight.

Watch while charging.

Your mophie powerstation go wireless is equipped with a fold-out kickstand so that you can easily watch your favorite movie or TV series while charging your phone.

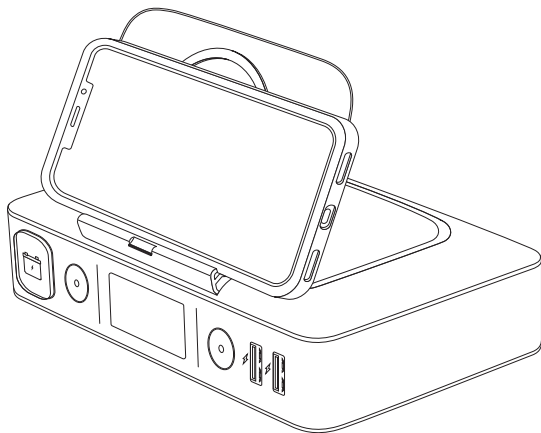

Specifications

Battery Cells: 3x 4000 mAh cells
Battery Pack Energy: 44400 mWh
Input: 14V DC/0.85A
Wireless Output: 10W
USB Output: 2 x USB 5V DC/2.4A
Dimensions: 182 mm x 97 mm x 40 mm
Weight: 590 g
Operating Temperature (Charge): 32°F - 113°F (0°C - 45°C)
Operating Temperature (Discharge): 14°F - 122°F (-10°C - 50°C)
Storage Temperature: -4°F - 131°F (-20°C - 55°C)

FCC Compliance Statement

This device complies with Part 15 of the FCC Rules.

Operation is subject to the following two conditions:

- This device may not cause harmful interference, and
- This device must accept any interference received, including interference that may cause undesired operation.

15.21

You are cautioned that changes or modifications not expressly approved by the party responsible for compliance could void the user's authority to operate the equipment.

15.105(b)

This equipment has been tested and found to comply with the limits for a Class B digital device, pursuant to Part 15 of the FCC rules. These limits are designed to provide reasonable protection against harmful interference in a residential installation. This equipment generates, uses and can radiate radio frequency energy and, if not installed and used in accordance with the instructions, may cause harmful interference to radio communications.

However, there is no guarantee that interference will not occur in a particular installation. If this equipment does cause harmful interference to radio or television reception, which can be determined by turning the equipment off and on, the user is encouraged to try to correct the interference by one or more of the following measures:

- Reorient or relocate the receiving antenna.
- Increase the separation between the equipment and receiver.
- Connect the equipment into an outlet on a circuit different from that to which the receiver is connected.
- Consult the dealer or an experienced radio/TV technician for help.

CAUTION: To comply with the limits of the Class B digital device, pursuant to Part 15 of the FCC Rules, this device must be used with certified peripherals and shielded cables. All peripherals must be shielded and grounded. Operation with non-certified peripherals or non-shielded cables may result in interference to radio or reception.

Limited warranty

What does this limited warranty cover and how long is the coverage?

mophie warrants its products to be free from defects in material and workmanship under normal use and service for a period of ninety (90) days beginning on the date your purchase the product.

What is not covered by this limited warranty?

This Limited Warranty does not cover defects or damage due to: (1) accidents, acts of God, misuse, abuse, abnormal use, abnormal conditions, improper storage, or exposure to liquid or moisture, (2) unusual or abnormal physical force or

impact, including dropping of the product, (3) connection of the product to improper voltage supply, or (4) attempted repair or modification by anyone other than mophie or a facility authorized by mophie.

What are mophie's obligations under this limited warranty?

Provided that you comply with the conditions of this Limited Warranty, during the duration of this Limited Warranty mophie will repair or replace the product, at its sole option, without charge. When repairing or replacing a product, mophie may, at its sole option, repair or replace the product with new, used, rebuilt or reconditioned parts or products. mophie will warrant any product that is repaired or replaced under this Limited Warranty for a period equal to the remaining time period under the original Limited Warranty or ninety (90) days, whichever is longer.

What are the limits of mophie's liability?

This Limited Warranty sets forth the full scope of mophie's obligations and liabilities with respect to the product. All implied warranties, including, without limitation, implied warranties of merchantability and fitness for a particular purpose, are limited to the duration of this Limited Warranty. In no event shall mophie be liable for any incidental, special, consequential or punitive damages or any damages or losses of or to electronic equipment or products that are used with any of mophie's products.

How does state law relate to this limited warranty?

Some states do not allow limitation on how long an implied warranty lasts or the disclaimer or limitation of incidental or consequential damages. Therefore, some or all of the disclaimers and limitations above may not apply to you.

FCC Radiation Exposure Statement

The device has been evaluated to meet general RF exposure requirement.

The device can be used in portable exposure condition without restriction.

 STAY POWERFUL®

www.mophie.com