



P1

Table of contents

1.Introduction	
1-1. Included Items	1
1-2. About BONX Application	2
1-3. About Online Manual	3
1-4. Names and Functions of the BONX Earpiece	4
2.Basic Operation	
2-1. Operation of the Power Button	6
2-2. About the LED Flicker	7
2-3. How to Charge	7
2-4. Firmware updates	7
3. Get started	
3-1. Download BONX App and Sign up	8
3-2. Assembly of BONX Earpiece	8
3-3. How to Wear BONX Earpiece	10
3-4. Pairing the BONX Earpiece with a Smartphone	12
3-5. Starting up BONX App	13
3-6. Conversation in the BONX Earpiece	14
3-7. Button Operation During a Conversation	16
3-8. Further Features to Customize BONX	17
4.For your safety	18

P2

1.Introduction

1-1.Included Items

The following items should be included in the case. After opening the case, please check if every item is indeed included. In case any item is missing, please promptly contact our customer support from our website.

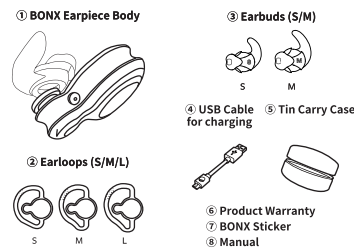

1

P3

1-2.About BONX application

This device works together with a smartphone application (BONX App). BONX App was designed for iOS and Android phones respectively. To download the application, please use the link below.



<https://bonx.co/>

P4

2

1-3.About Online Manual

Operation of the BONX App is subject to change in accordance with the updates of the BONX App. For the latest method of operation, please check the online manual.

> How to access the manual from the web
<https://bonx.co/support/manual>



> How to access the manual from the app
Open "ACCOUNT" page from the menu, and choose "Manual".



3

P5

1-4.Names and Functions of the BONX Earpiece

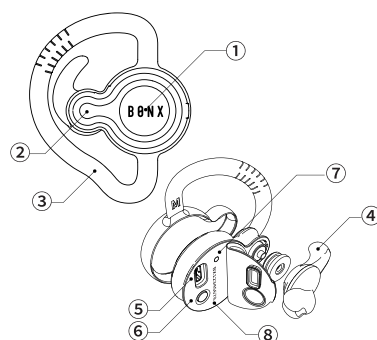

P6

4

① Multi-functional Button

- Continuous press for 1 second to switch on the Mic "Mute". For more information, please refer to the "3-7. Button Operation During a Conversation".
- When not used together with the BONX App, Multi-functional Button could be utilized for receiving/disconnecting incoming calls.

② Volume Button

- You can adjust the volume by separate single clicks. The volume adjustment has seven steps.
- Continuously press for 1 second to switch on the "Silent Mode". For more information, please refer to the "3-7. Button Operation During a Conversation".

③ Earloops

- S/M/L 3 different sizes included.

④ Earbuds

- S/M 2 different sizes included.

⑤ Battery Charger Port

- To charge BONX Earpiece, please connect the microUSB Cable to the port.

⑥ Power Button

- Information on how to operate the Power Button is included in the section "2-1. Operation of the Power Button".

⑦ LED light

- Flashing pattern and color indicate status of the power ON/OFF. For detailed information, please refer to the "2-2. LED Flashing".

⑧ Serial Number

- It is a unique digit ID that identifies your BONX Earpiece.

- When connecting the smartphone with the BONX Earpiece through Bluetooth, please check the ID accordingly.

- For details about the pairing method, please turn on to the "3-4. Pairing the BONX Earpiece with a Smartphone".

5

P7

2.Basic Operation

2-1.Operation of the Power Button

1.Power ON/OFF

To turn on the BONX Earpiece, simply press the Power Button for 1 sec. The Green LED light will turn on for 1 second. To turn off the device, please press the button again for 1 second. The LED light will turn Orange for 1 second.

2.How to start a Pairing Mode

The device would automatically switch to a Pairing Mode after turning on. To switch to the Pairing Mode manually, please press the Power Button for 6 continuous seconds. The LED light would flash Green and Orange alternately.

* After confirming the power is on, please press and hold the Power Button.

3.Connection History Reset

If you require device connection reset, please press and hold the Power Button for 15 seconds after the device is turned off. The LED light should alternately blink Green and Orange colors before it turns Yellow for 1 second.

P8 6

2-2.About the LED Flicker

Green LED lights up for 1 second	Power on
Orange LED lights up for 1 second	Power off
Green and Orange LED lights flash alternately	Pairing
Green LED flash (7 seconds intervals)	Connecting to smartphone
Orange LED lights up	Charging
Green LED lights up	Charged
Orange LED flash	Low battery, need to charge immediately

2-3.How to Charge

BONX Earpiece is rechargeable. To charge, open the rubber back cover of the device. Insert the microUSB Cable to the charging port on the back side. It will start charging once connected to a personal computer or other electric devices.

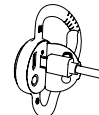

2-4. Firmware updates

Firmware updates are sent regularly whenever new features are added or bugs are fixed. You can get the newest update either by plugging in the microUSB Cable to the PC, or by wireless connecting through smartphone application. For more information, please follow the guidance from the BONX App.

P9 7

3.Get started

3-1.Download BONX App and Sign up

To take advantage of the BONX call system, iOS or Android version of BONX App should be downloaded. Search "BONX: The Way We Talk" from App Store or Google Play, or go to our website directly.



<https://bonx.co/>

3-2.Assembly of BONX Earpiece

M size Earloop is already attached to the BONX Earpiece Body.

Please choose and interchange the correct size Earloop according to your ear size. Size of the Earloop is shown on the back of the Earloop in alphabets as illustrated in the drawing.



P10 8

After selecting the optimum size, pull the loop into the bigger circle of the BONX Earpiece Body as shown on the picture. Then hook the rest. It should be mounted so as to fit the outer periphery of the BONX Earpiece Body.



The Earbud is not attached to the BONX Earpiece Body at the packaged stage. As there are S and M two different sizes, please choose the one that fits your ear hole. Size is given in the Earbud body in alphabets as illustrated on the drawing. After selecting the optimum size, please mount the Earbud covering the speaker portion of the device. Turn the Earbud and adjust to fit into the recess of the ear.

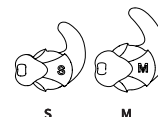

P11 9

3-3.How to Wear BONX Earpiece

1. First, attach the Earbud onto the device and see if the cap correctly fits to the recess of the ear.



2. Then, wear the top part of the Earloop on the upper part of the ear, and hook it entirely around the ear.

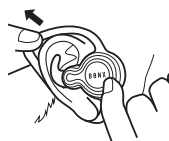

P12 10

3. Back part of the Earloop should be resting on the back of your ear, while the Earloop should encircle your outer ear.



4. Test by shaking your head if the device is properly fitted and doesn't move.

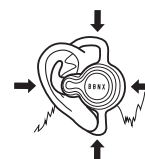

P13 11

3-4.Pairing the BONX Earpiece with a Smartphone

1. After confirming that the Bluetooth of your smartphone is enabled, please turn on the BONX Earpiece.

2. When you turn on the device for the first time, it will automatically switch to the Pairing Mode. Please make sure that LED is alternately blinking Green and Orange colors.

3. If the device doesn't switch to the Pairing Mode automatically, please hold and press for 6 continuous seconds. This will manually switch to the Pairing Mode.

* On how to use the Power Button, please check "2-1. Operation of the Power Button".

4. Open the setting page of the smartphone Bluetooth function to connect with the BONX Earpiece. From the list, please select the device starting with "BX2*****". The applicable serial number should be identical to the one that is shown beside the Power Button on the back side of the device.

* Serial number is specific to each device. For additional information,

P14 12

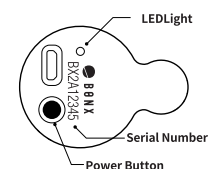

3-5.Starting up BONX App

Once the Bluetooth connection is completed, start the BONX App. Sign up according to the guidelines from the application. A sound effect would be activated when you are connected successfully.

P15 13

3-6. Conversation in the BONX Earpiece

To start the conversation, please add friends and create a group conversation.

- In a "① NEARBY" list, people using the BONX App nearby will be displayed.
- A friend who has called recently will be shown in a "② RECENT" list.
- In addition, if you have logged in through a Facebook account, your friends on Facebook using the BONX App will be displayed in a "FACEBOOK" list.
- Direct ID search is available in case you want to talk to your friend for the first time using the BONX App, or if you cannot find your friend on the "NEARBY" lists. For doing so, please simply input your friends' ID to a "③ SEARCH YOUR FRIEND'S NAME OR ID" window on the top.
- Once you have selected your friends, press the "④ CALL" button to invite them to the group conversation.

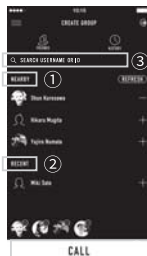

P16 14

- When you are invited to the conversation, a pop up screen will appear indicating "⑤ \$ACCEPT" or "⑥ \$DECLINE" buttons. When you accept, the conversation will start automatically. While 1 member of the group conversation sends invitations for the others, other members should only wait for that. When they accept the invitation, the group conversation starts immediately.
- You can access a group conversation from the past from a "⑦ \$HISTORY" Tab. In addition, it is possible to re-join the previously left group conversation. When the group conversation is still active, ⑦ the call symbol is displayed in Green.



15 P17

3-7.Button Operation During a Conversation

If you press the BONX Earpiece buttons during a call, Mute, Silent or Volume Control functions can be accessed.



1. Volume Control

To adjust the volume, please press the Volume Button. Volume Control is divided into 7 adjustment steps.

2. Silent Mode

During the group conversation, you can start the "Silent mode" by pressing and holding the Volume Button for 1 second. On the mode, both Mic and Speaker of the BONX Earpiece turn off. Your voice cannot be heard by the other members, and the group conversation will not be transmitted to your

P18 16

speaker. Please use this mode when you want to concentrate on your own activity. You can come back to the group conversation by pressing and holding the Volume Button for 1 second again.

2. Mic Mute

During a group conversation, if you don't want your voice transferred to the group members, you can turn your Mic on "Mute" by pressing the Multi-functional Button for 1 second. When the Mic is muted, you can still hear the conversation of the group mates. To turn on the Mic, simply press the Multi-functional Button for 1 second again.

3-8.Further Features to Customize BONX

We will be adding more and more useful features to the BONX application. For the latest feature information, please check the online manual. It should be noted that, for further improvements of the user experience, what is described in this manual is subject to change without prior notice.

4.For your safety

4-1.Warning

- When using the product, be careful not to disturb other people around you.
- Do not use in areas where it is dangerous to be unable to hear ambient noise around you

17 P19

Pay careful attention when using while performing work that requires your full attention.

- When using the product, pay careful attention to traffic conditions, pedestrian traffic, and so on; follow all road traffic laws and regulations (hereinafter referred to as "traffic laws") while using the product. There is the possibility of causing a traffic accident when using the product.
- There may be cases where wearing headsets while operating an automobile, bicycle, or motorcycle is regulated by local traffic laws. Please contact your local municipality before using.
- When using the product, check to make sure the product itself is firmly in place in order to prevent the Earloop and the Earbud from coming off.
- In the unlikely event that the Earbud comes off and remains in your ear, do not forcibly remove it; seek medical advice and follow the instructions of medical staff.
- Pay careful attention not to turn the volume up too high on connected equipment. Exposure to loud sounds for extended periods of time has the risk of damaging ears and causing hearing loss. Before using, carefully check the volume before placing against the ear.
- This product uses a rechargeable battery. A new battery will charge up to its full capacity only after first being fully charged and fully depleted 2-3 times. Do not leave a fully charged battery connected to the charger. Overcharging will shorten the life of the battery.
- Keep the battery in a place with a temperature range of 0-45°C. Placing in a location outside that temperature range—an extremely hot or cold location (for example, somewhere in direct sunlight or inside a hot car) in summer or winter—may result in the following: leakage, overheating, rupture, discharge, and the shortening of the life of the battery. Even if fully charged, there may be cases where the product does not work temporarily.
- Submitting the product battery to any of the following may cause fires or chemical burns: strong physical impacts; electrically charged materials contacting the battery electrode; overcharging and over-discharging through use of rapid chargers and so on; handling incorrect . Damaged batteries may generate heat and have the danger of exploding.

P20 18

- Because the product battery was not designed to be replaced with other batteries, removing the product battery and replacing with other batteries is prohibited. Removing and replacing the battery is dangerous and has the risk of damaging the product.
- When disposing of the battery, please follow local laws and regulations. Recycle as much as possible; do not dispose of the battery in your normal household waste; do not burn. There is a risk of explosion.
- This product contains small parts and cords that may become stuck in the throat and cause suffocation. Please store out of reach of children. If children use the product, there is the possibility it could cause serious injury or death.
- Do not submit the product body to strong impacts. Strong impacts may cause damage or product failure.
- Do not use if the product is damaged or broken. We assume no responsibility if the product is used in a damaged or broken state.
- We assume no responsibility in the case of any accident that occurs if the product is used in a way that does not follow the provided safety precautions, or is used in a way that deviates from the intended use or laws and regulations, such as traffic laws, provided in the safety precautions.

4-2.Caution

- The intended use of the product is, in conjunction with our smartphone application, for group calls in the context of sports, including skiing, snowboarding, cycling, fishing, and so on. This product has been developed and designed to be used with our smartphone application. We do not offer support related to how to use our smartphone application on smartphones other than those specified. We ask for your understanding.
- For information about how to obtain our smartphone application, please see "1-2. About BONX Application". The BONX App is subject to update without prior notice.
- Do not place near heating equipment, in dusty or hot areas, in direct sunlight, or where the product may come in contact with water. Doing so may cause the product to break.

19 P21

- The product body has been waterproof treated to a level equivalent to IPX5 (water resistant), but it is not completely waterproof. Do not intentionally submerge in water or use in water. Also, if the product becomes wet, wipe dry with a dry cloth. If moisture remains in sound emitting areas, sounds may be muffled or there may be no sound. In such cases, wrap the product body in a dry cloth and shake approximately 20 times until the moisture has been completely dried. Hair dryers and other sources of hot air may cause damage to the product body; do not use such devices.
- When removing the charge cable from the BONX earpiece, do not pull on the cord; make sure to pull while holding on to the plug.
- To clean dirt from the exterior of the BONX earpiece, wipe with a soft towel. For particularly stubborn stains, wipe with a cloth moistened with a mild detergent. Paint thinner, benzene, and alcohol will damage the surface finish; do not use them.
- Operating within the frequency band used by this product are industrial, scientific, and medical equipment, factory production lines, and so on, where private radio stations for mobile identification are used (radio stations requiring licenses), as well as low-power radio stations (radio stations that do not require licenses). Before using the product, confirm that these types of radio stations are not operating nearby. In the unlikely event of radio interference between the product and these types of radio stations, refrain from using the product and address the issue promptly, such as by changing locations. This product is a wireless device featuring a sophisticated built-in 2.4GHz band data communication system. The modulation system uses FH-SS.
- The Bluetooth product name and logo are registered trademarks of Bluetooth® SIG, Inc. BONX INC. uses all of these based on a license.
- The App Store is a service trademark of Apple Inc.
- iPhone is a trademark of Apple Inc., registered in the US and other countries.
- Android™ is a trademark of Google Inc.
- BONX™ and the BONX™ logo are trademark registered in Japan, and registrations pending in the United States and other countries by BONX INC.

P22 20

- All brands described in the instruction manual are protected property of their respective owners.
- Designs, specifications and what is described in this manual are subject to change without prior notice.

FCC Statement

Changes or modifications not expressly approved by the party responsible for compliance could void the user's authority to operate the equipment. This equipment has been tested and found to comply with the limits for a Class B digital device, pursuant to Part 15 of the FCC Rules. These limits are designed to provide reasonable protection against harmful interference in a installation. This equipment generates uses and can radiate radio frequency energy and, if not installed and used in accordance with the instructions, may cause harmful interference to radio communications. However, there is no guarantee that interference will not occur in a particular installation. If this equipment does cause harmful interference to radio or television reception, which can be determined by turning the equipment off and on, the user is encouraged to try to correct the interference by one or more of the following measures: — Reorient or relocate the receiving antenna. — Increase the separation between the equipment and receiver. — Connect the equipment into an outlet on a circuit different from that to which the receiver is connected. — Consult the dealer or an experienced radio/TV technician for help. This device complies with part 15 of the FCC rules. Operation is subject to the following two conditions: (1) this device may not cause harmful interference, and (2) this device must accept any interference received, including interference that may cause undesired operation.



1610V1

21 P23