



**Make It Yours.**

# CH351

## USER MANUAL

UNCOMPROMISED FREEDOM



## FCC SAFETY NOTICE

This equipment has been tested and found to comply with the limits for a Class B digital device, pursuant to part 15 of the FCC Rules. These limits are designed to provide reasonable protection against harmful interference in a residential installation. This equipment generates uses and can radiate radio frequency energy and, if not installed and used in accordance with the instructions, may cause harmful interference to radio communications. However, there is no guarantee that interference will not occur in a particular installation. If this equipment does cause harmful interference to radio or television reception, which can be determined by turning the equipment off and on, the user is encouraged to try to correct the interference by one or more of the following measures:

- Reorient or relocate the receiving antenna.
- Increase the separation between the equipment and receiver.
- Connect the equipment into an outlet on a circuit different from that to which the receiver is connected.
- Consult the dealer or an experienced radio/TV technician for help

Changes or modifications not expressly approved by the party responsible for compliance could void the user's authority to operate the equipment.

This device complies with Part 15 of the FCC Rules. Operation is subject to the following two conditions:

- (1) this device may not cause harmful interference, and
- (2) this device must accept any interference received, including interference that may cause undesired operation.

This equipment complies with FCC radiation exposure limits set forth for an uncontrolled environment.

## CE COMPLIANCE STATEMENT

Hereby, Cooler Master Technology Inc. declares that the radio equipment type CH351/CH-351/CH-351-MC/CH-351-xxxxxx/CH351-xxxxxx/CMHS-D (The symbol "\*" can be 0-9,A-Z, a-z, "/", "\", "\_", "-", "(", ")", ",", "." or blank for the marketing purpose, only different model designations on the marking plate for different markets. No safety concerns.) is in compliance with Directive 2014/53/EU

The full text of the EU declaration of conformity is available at the following internet address:  
<https://coolermaster.egnyte.com/fl/z2r01jkETE>



The power delivered by the charger must be between min 2.5 Watts required by the radio equipment, and max 5 Watts in order to achieve the maximum charging speed.

# OVERVIEW

- 1 Right light
- 2 Right hole
- 3 Left switch
- 4 Left switch
- 5 Left switch
- 6 Left hole
- 7 Left hole
- 8 Left button
- 9 Front light
- 10 Front light

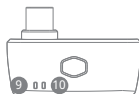
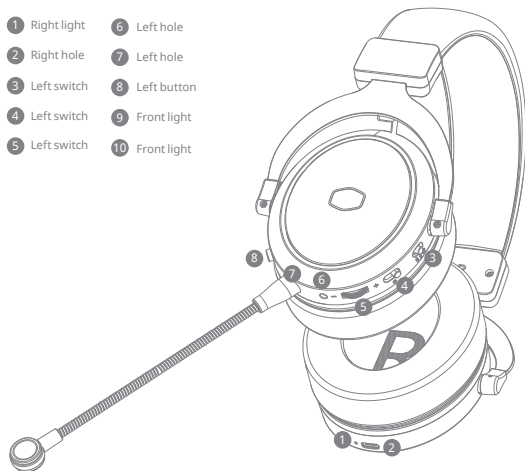

- |                                 |                            |                           |
|---------------------------------|----------------------------|---------------------------|
| 1 Status and Charging indicator | 2 USB Type C charging port | 3 Microphone and Sidetone |
| 4 MFB                           | 5 Volume control           | 6 3.5mm audio jack        |
| 7 Boom Microphone jack          | 8 3D sound control         | 9 Status indicator        |
| 10 3D sound indicator           |                            |                           |

# ATTENTION

Please charge your new headphone for at least 2 hours before using for the first time.

## MFB

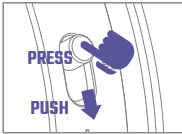

## 2.4GHz Connect

Function	Instruction / Description	LED Status	Voice Prompt
Power On	Push and hold "MFB" for 2 seconds	● Red LED flashes once	Power on
Connecting	Power on and enter to connection searching	●●●●●● Green LED slow flash	/
Manual Pairing	<b>*It's already be paired at factory, please avoid using when not necessary.*</b> Power on then press "MFB" for 6 seconds Insert a paper clip or a SIM-eject tool into the hole back of the dongle for 6 seconds.	●●●●●● Green LED fast flash	Pairing
Connected	Connection mode	■ Green LED steady	Connected
Connect Fail	Power off after 5 minutes	●●●●●● Green LED slow flash for 5 minutes	/
Disconnect	Unplug the dongle	●●●●●● Green LED slow flash for 5 minutes	Disconnect
2.4GHz and BT Switch	Under power on, press "MFB" twice	As connection status	Low Latency or Bluetooth
Power off	Under power on, Push and hold "MFB" for 4 seconds	●● Red LED fast flash twice and off	Power off

## Bluetooth Connect

Function	Instruction/Description	LED Status	Voice Prompt
Power On	Push and hold "MFB" for 2 seconds to power on then press "MFB" twice enter to BT mode	● Red LED flashes once	Power on -> Bluetooth
BT Searching	With pairing record: Auto enter while switching from 2.4GHz mode to Bluetooth	●●●●●● Blue LED slow flash	/
Pairing *The 1st device only*	When switch to BT mode, it will automatically to pairing stausts if the headset doesn't have pairing record	●●●●●● Blue LED fast flash	Pairing
Manual Pairing	Under power on, press "MFB" for 6 seconds	●●●●●● Blue LED fast flash	Pairing
Connected *w/ 3 devices pairing record*	Connection status	■ Blue LED steady	Device one Connected / Device two Connected / Device three Connected
Disconnect	Disconnect with device, power off after 5 minutes disconnected	●●●●●● Blue LED slow flash for 5 minutes	Disconnect
BT Devices Switch *W/ a pairing record for more than 2 devices, the maximum is 3 devices*	Under BT mode, press "MFB" once to switch	●● Blue LED fast flash twice and off	Device One, Device Two, Device Three
Power Off	Under power on, Push and hold "MFB" for 4 seconds	●● Red LED fast flash twice and off	Power off

# Mic and Sidetone



Instruction/Description		Voice Prompt
1	Sidetone ON Microphone ON	Sidetone on
2	Sidetone OFF Microphone ON	Sidetone off
3	Sidetone OFF Microphone MUTE	Microphone mute

# 3D Surround

Function	Instruction/Description	LED Status
3D Sound On	Press to active the effect	<div></div> White LED steady
3D Sound Off	Release to turn off the effect	Off

# Volume Control

Function	Instruction/Description
Volume up	Push up
Volume down	Push down

# Charging

Power Description	LED Status	Voice Prompt
Low Battery	<div></div> Red slow flash	Low Battery
Charging	<div></div> Red LED steady	/
Charging Completely	<div></div> Blue LED steady	/

# Line In

Connect	Instruction/Description	Power	3D Surround	Sidetone	Microphone Mute	Volume
Analog listen	Connect with 3.5mm audio cable	Disable	Disable	Disable	Disable	Disable

# Safety Guide

## Safety instructions

- Read these operating instructions carefully and completely before using the product.
- Do not use the product when it is damaged.

## PREVENTING DAMAGE TO HEALTH AND ACCIDENTS

- When you use the headphones, please make sure that the volume level is set to minimum. Adjust the volume level only after putting on the headphones. To avoid possible hearing damage, do not use your headphones for extended periods of time at high volume.
- High volumes and long listening times can damage your hearing. Hearing damage is irreversible.
- If you suffer from tinnitus, do not use headphones or reduce the volume.
- Always ensure an adequate volume level. It is advisable to keep listening times as short as possible at high volume levels.

## DANGER TO YOUR PERSON

- Headphones drastically reduce perception of external sounds. Using headphones in road traffic can be potentially dangerous. The user's hearing must not be impaired to the extent that it causes road safety risks. For your safety, please do not use the headphones in traffic, especially within an area of potentially dangerous machines and tools.
- Furthermore, avoid using headphones in situations where hearing must not be affected, especially at railway crossings or construction sites.

## Liability / intended use

- Do not use the product for any application which is not described in this product information. Cooler Master is not liable for improper use of the product and its accessories.
- Cooler Master is not liable for damages to USB devices that do not comply with USB specifications.
- Cooler Master is not liable for damages resulting from transmission breakdowns due to empty or old batteries or exceeding the Bluetooth® transmission range.
- Please observe the respective country-specific regulations before using the product.

## Unit usage warning

- Use only a USB 2.0/3.0 compliant 5V power supply to charge the battery via the integrated USB type-C port (power consumption is max. 1.0 A).
- WARNING: The batteries (battery pack or batteries installed) shall not be exposed to excessive heat such as sunshine, fire or the like.
- CAUTION: Please do not open the housing. Danger of explosion if battery is incorrectly replaced.

## Battery warning

- Do not disassemble.
- Do not use the battery after soaking.
- Do not expose to high temperature (60 °C/140 °F). High temperatures, particularly in association with a high charging status, result in irreversible damage of the battery.
- If you are not intending to use the battery for an extended period or are planning to put it into storage, it is advisable to lower the battery's charging level to around 50% and to store it at temperatures of maximum 30 °C.
- Never expose the battery to excessive heat such as sunshine, fire or the like.
- Misuse or improper use could damage the battery. In extreme cases, there is a risk of explosion, heat, fire, smoke or gas.

## Notes on battery life for Li-ion batteries

- After fully charging, disconnect the charging cable from the charger and the headphones.
- High temperatures, especially when fully charged can lead to irreversible damage.
- If the battery is not used for extended periods of time, it is recommended to charge it to approx. 50 % and store it at temperatures no more than 20 °C.
- Turn-off the battery-powered product after use.

## Battery disposal

When this product reaches its end of life, take it to a collection point designated by local authorities. The separate collection and recycling of your product and/or its battery at the time of disposal will help conserve natural resources and ensure that it is recycled in a manner that protects human health and the environment.

- Old batteries may contain substances that are harmful to your health and environment.
- Dispose used batteries always according to the applicable disposal regulations. Please do not throw used battery packs into the fire (danger of explosion) or your household rubbish, take them to your local collection points.

## Technical specifications

Bluetooth transmitter frequency range.....	2402-2480 MHz
Bluetooth transmitter power.....	≅ 8 dBm (EIRP)
Bluetooth transmitter modulation.....	GFSK, π/4 DQPSK, 8DPSK
2.4GHz SRD frequency range.....	2402-2476 MHz
SRD transmitter power.....	≅ 10 dBm (EIRP)
Operating temperature range .....	0 to 60 °C
Charging temperature range .....	0 to 45 °C

## Trademarks

The Bluetooth® word mark and logos are registered trademarks of Bluetooth SIG, Inc. and all use of these trademarks by Cooler Master is licensed. Other trademarks and trade names are the property of the respective owners.