



ATACS

Instruction Manual

Table of Contents

ATACS Overview	3
How to Properly Fit the ATACS	4
Basic Features	5
Bluetooth Features	6
Get the Walker's LINK App	7
NRR Information	8
FCC Compliance	10
Limited Warranty	11
Warranty Registration	12

Contact Us

WEBSITE
www.walkersgameear.com

GSM, LLC
P.O. Box 535189
Grand Prairie, TX 75053-9504

CUSTOMER SERVICE
CONTACT & HOURS
Toll Free: 877-269-8490

CALL CENTER HOURS
Mon – Fri / 8 AM – 5 PM (CST)

ATACS Overview



How to Properly Fit the ATACS Earbud



Step 1: Select the proper size foam ear bud tips to fit your ear canal. This foam tip should form a complete seal, blocking out sound. This is critical to achieve the highest possible NRR rating and protect your hearing.



Step 2: Compress the foam tip by rolling or pinching between your fingers until it becomes malleable.

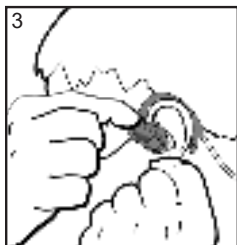

Step 3: Insert the foam tip into the ear canal as deep as it is comfortable to wear. Pulling the earlobe back makes it easier to insert the foam tip.

Step 4: Hang the ear hook over the ear. Hold in place for 10 seconds to ensure the earplug expands and seals in the ear canal.

Step 5: Repeat for the other ear.

Outside noises should be significantly reduced. If not, remove the earplugs and perform the steps again until a good seal is made.

NOTE: Fitment instructions can also be found on the app.

Basic Features

To Power On

Press and hold Multi-Button for 2 seconds.
An audible notification will play ***“Walker’s”***



Ambient Volume Adjust

Ambient Volume is controlled by the left earbud.
A double beep will sound when volume reaches its maximum or minimum level.



Increase Ambient Volume



Decrease Ambient Volume

4 Operation Modes

Cycle through operations by pressing both + and - buttons at the same time.

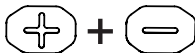

- **Universal:** General use with no filter applied
- **Clear Voice:** Amplified vocal frequencies
- **High Frequency:** Amplified vocal and high frequencies
- **Power Boost:** Amplified version of Universal

Charging

Open the bottom flap on the right earbud. Plug a USB-C cable into the charging port.

RED charging port LED: charging

BLUE charging port LED: fully charged

Bluetooth Features

Pairing Mode

The ATACS enters Pairing mode automatically when no previous paired device profile is present.

Pairing the ATACS to a New Phone

Start with the ATACS powered off. Press and hold the Multi-Button for 5 seconds to forget the previously paired device.



An audible notification will play **“Pairing”**, the earbud enters Pairing Mode, and the LED will flash red and blue.

Navigate to your phone's Bluetooth setting and select **“WALKERS ATACS”** from your list of available Bluetooth devices. An audible notification **“Connected”** will confirm a successful connection has been made. While paired to a phone, the LED will remain off.

Pairing mode will timeout after 60 seconds.

Phone Calls

- To answer a call, short press the Multi-Button
- To reject a call, press and hold the Multi-Button for 1sec
- To end a call, short press the Multi-Button
- To redial the last phone number, double press the Multi-Button
- To put a call on hold and take a second call, double press the BT button
- To switch back to the first call, short press the BT button. This will end the second call.

Playing Audio

- To Play/Pause music, short press the Multi-Button
- To skip to next track, press and hold Vol +
- To skip to previous track, press and hold Vol -

Get the Walker's LINK APP

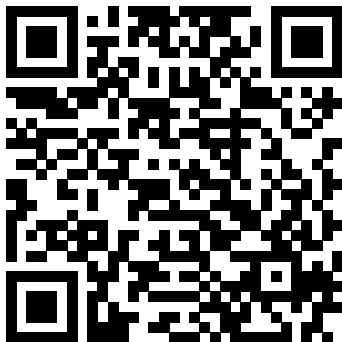

NRR Information

Although hearing protectors can be recommended for protection against the harmful effects of impulsive noise, the Noise Reduction Rating (NRR) is based on the attenuation of continuous noise and may not be an accurate indicator of the protection attainable against impulsive noise such as gunfire.

The level of noise entering a person's ear, when hearing protector is worn as directed, is closely approximated by the difference between the A-weighted environmental noise level and the NRR.

Example:

1. The environmental noise level as measured at the ear is 92 dBA.
2. The NRR is **24** decibels (dB)
3. The level of noise entering the ear is approximately equal to [92dB-22dB]

Caution: For noise environments dominated by frequencies below 500 Hz the C-weighted environmental noise level should be used.

Test Method: A501 (3.15 - 1000)
 Manufacturer: SGM
 Model: SFED

Position: none
 Date: 10/2/21
 Test ID: 02071A

S.F.A. Freq	Frequency (Hz)								
	120	180	240	300	360	420	480	540	600
1	13	14	17	19	22	26	30	37	47
	12	12	14	14	15	17	18	20	22
	14	15	17	18	19	20	21	22	23
2	15	16	19	21	23	27	30	37	47
	14	14	16	16	16	18	19	20	21
	16	17	19	20	21	22	23	24	25
3	17	18	21	23	25	29	32	39	49
	16	16	18	18	18	20	21	22	23
	18	19	21	22	23	24	25	26	27
4	19	20	23	25	27	31	34	41	51
	18	18	20	20	20	22	23	24	25
	20	21	23	24	25	26	27	28	29
5	21	22	25	27	29	33	36	43	53
	20	20	22	22	22	24	25	26	27
	22	23	25	26	27	28	29	30	31
6	23	24	27	29	31	35	38	45	55
	22	22	24	24	24	26	27	28	29
	24	25	27	28	29	30	31	32	33
7	25	26	29	31	33	37	40	47	57
	24	24	26	26	26	28	29	30	31
	26	27	29	30	31	32	33	34	35
8	27	28	31	33	35	39	42	49	59
	26	26	28	28	28	30	31	32	33
	28	29	31	32	33	34	35	36	37
9	29	30	33	35	37	41	44	51	61
	28	28	30	30	30	32	33	34	35
	30	31	33	34	35	36	37	38	39
10	31	32	35	37	39	43	46	53	63
	30	30	32	32	32	34	35	36	37
	32	33	35	36	37	38	39	40	41
Mean ± 1 SD									
Min = 24 dB									

Use these laboratory derived data for consideration purposes only. The amount of protection afforded in field use is often significantly lower depending on how the protectors are fitted and worn.

FCC Compliance



FCC Statement:

This device complies with Part 15 of the FCC Rules. Operation is subject to the following two conditions. (1) this device may not cause harmful interference, and (2) this device must accept any interference received, including interference that may cause undesired operation.

FCC Caution:

Changes or modifications not expressly approved by the party responsible for compliance could void the user's authority to operate the equipment.

NOTE: This equipment has been tested and found to comply with the limits for Class B digital device, pursuant to part 15 of the FCC Rules. These limits are designed to provide reasonable protection against harmful interference in a residential installation. This equipment generates, uses, and can radiate radio frequency energy and, if not installed and used in accordance with the instructions, may cause harmful interference to radio or television receptions, which can be determined by turning the equipment off and on, the user is encouraged to try to correct the interference by one or more of the following measure:

- Reorient or relocate the receiving antenna.
- Increase the separation between the equipment and the receiver.
- Connect the equipment into an outlet on a circuit different from that to which the receiver is connected.
- Consult the dealer or an experienced radio/TV technician for help.

Shielded interference cable must be used with the equipment in order to comply with the limits for a digital device pursuant to Subpart B of Part 15 of FCC Rules.

Specifications and designs are subject to change without any notice or obligation on the part of the manufacturer.

The Device has been evaluated to meet general RF exposure requirement. The Device can be used in portable exposure condition without restriction.

IC NOTE

This device contains license-exempt transmitter(s)/receiver(s) that comply with Innovation, Science and Economic Development Canada's license-exempt RSS(s). Operation is subject to the following two conditions:

1. This device may not cause interference.
2. This device must accept any interference, including interference that may cause undesired operation of the device.

L'émetteur/récepteur exempt de licence contenu dans le présent appareil est conforme aux CNR d'Innovation, Sciences et Développement économique Canada applicables aux appareils radio exempts de licence. L'exploitation est autorisée aux deux conditions suivantes :

- 1) L'appareil ne doit pas produire de brouillage;
- 2) L'appareil doit accepter tout brouillage radioélectrique subi, même si le brouillage est susceptible d'en compromettre le fonctionnement.

The device has been evaluated to meet general RF exposure requirement. The device can be used in portable exposure condition without restriction.

Le matériel a été évalué pour répondre aux exigences générales d'exposition aux radiofréquences. Le dispositif peut être utilisé dans des conditions d'exposition portables illimitées.

Limited Warranty

Walker's warranties this product to the original purchaser to be free from defects in materials and workmanship, under normal use and conditions for a period of one year parts from the date of purchase.

Under this warranty, this device will be replaced or repaired at our option. Copy of the original receipt or gift receipt, is required for any warranty service. To enact the warranty, the customer is required to contact our Customer Service Group at 877-268-8490 to receive a Return Authorization (RA) number PRIOR to sending the product back.

This warranty is void if any of the following occur:

1. The device is not accompanied by a copy of the receipt or gift receipt from the original purchaser.
2. The device has been tampered with, opened or punctured.
3. The device has been immersed in water or other liquids, allowed to be filled with dirt or dust, or otherwise physically abused.
4. The one year limited warranty has expired. Please inquire about other options from your Customer Service Representative.

This shall be the exclusive written warranty of the original purchaser and neither this warranty nor any other warranty, expressed or implied, shall extend beyond the 12-month period listed above. In no event shall Walker's, Inc. be liable for consequential property damage, or consequential personal injury. (Some states do not allow limitations on implied warranties or exclusions of consequential damages, so that these restrictions may not apply to you). This warranty gives you specific legal rights, and you may have other rights, which vary from state to state.

Record Serial # for future reference: Serial # _____

Return page 12 of manual to Walker's, Inc. – PO Box 535189 – Grand Prairie, TX 75053-5189

Warranty Registration

Model: _____ Date of Purchase: _____

Purchased From: _____

City: _____ State: _____ Zip: _____

Primary Use: _____

Your Name: _____

Address: _____

City: _____ State: _____ Zip: _____

Email Address: _____ Serial #: _____

©2018 Google LLC, used with permission. Google and the Google logo are registered trademarks of Google LLC.
Apple and iPhone are trademarks of Apple Inc., registered in the U.S. and other countries.