

90.01 mm

90.00 mm

6IN1 Fast Wireless Charger

User Manual

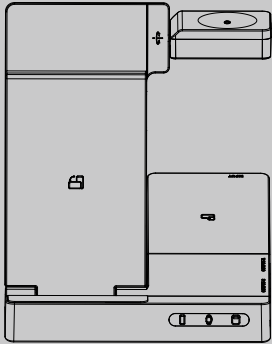

Important: to charge 3 devices safely and effidently,a 9V/2.5A 12V/2A or above adapter(Qualcomm Quick Charger2.0 or 3.0)and a quick charge cable are required Otherwise,the charger may not work normally and may even get damaged

Product Overview

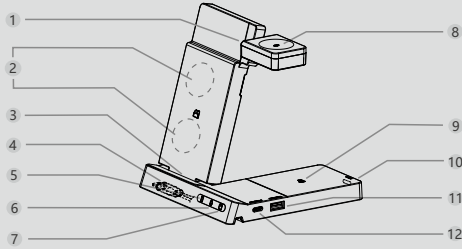

- | | | |
|------------------------------|-------------------------------------|----------------------------|
| 1 Watch rotation angle | 5 Phone charge LED indicator | 9 TWS earphone charge area |
| 2 Phone charge | 6 Smart watch charge LED | 10 Type-C Port |
| 3 Phone rotation angle | 7 TWS earphone charge LED indicator | 11 USB Output |
| 4 Lightning or Type-C Output | 8 Smart watch charge area | 12 Type-C Output |

Product Introduction

The 6-in-1 wireless charger, powered from only one outlet, can charge 3 devices simultaneously. Charge will start after you put on your smart phone, smart watch or earphone. Featuring compact design, the charger requires less storage space and brings you a well-organized charge experience.You can learn the charge progress easily by the LED indicator.

Operation Steps

- 1.Connect the charger to a 9V/2A QC3.0 adapter through a type-C quick charge cable to switch on the power;
- 2.Put your device onto the specified area;
- 3.Then the charging proess will start automatically;

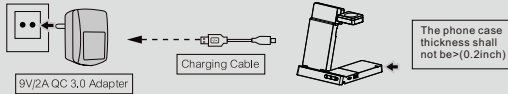

Charging Schematic Diagram

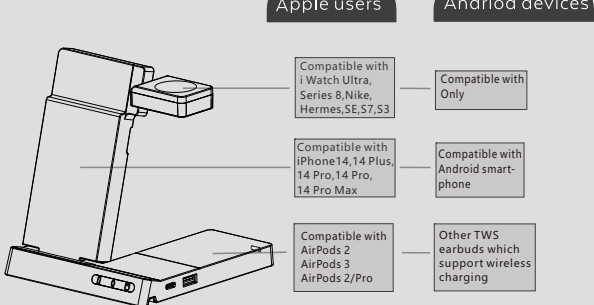

LED indicator

- | | | |
|---|--|--|
| • Red light is on: Standby mode or not charging | • Green light is on: Wireless charging | • Red and Green light is flash: Foreign body is detected is misaligned (charging will automatcally stop) |
|---|--|--|

Compatible Devices

- 1.Smart Phone:
Apple:iPhone14,14 Plus,14 Pro,14 Pro Max,13,13 Pro,13 Pro Max,13 mini, 12,12 Pro,12 Pro Max,MINI,SE,11,11 Pro,11 Pro Max,Xs,Xs Max,XR,X,8,8 Plus;
Samsung:Galaxy S:22,22 5G,22+5G,22 Ultra 5G,21 5G,21 +5G,21 Ultra 5G,FE 5G, 20 5G,20+5G,20 Ultra 5G,10,10+,10e,9,9+,8,8+,7,7 edge,6,6 edge,6 edge+, 6G9209,6Active;Galaxy Note:10,10e,10+,9,8,7,6,5;
LG:G2(VS980,Verizon version),G3,G6,G6+,G7,G7 ThinQ,G7+ThinQ,G8,G8 ThinQ, V30,V30+,V35,V40 ThinQ,V50,V50 ThinQ,LG Lucid2 (VS870),LG Optimus F5(As870), LG Optimus Vu 3,Spectrum 2,Optimus G Pro,OptimusVull,Optimus LTE 2,etc.
MOTOROLA:Droid Turbo,Droid Turbo2,Droid 5,Moto Maxx,Ultra M,Moto X Force.
Huawei:P50,P50 Pro,P40 Pro,P40 Pro+,P30 Pro, Mate:40E,40 RS,40 Pro+,40 Pro,40,30E Pro,30 5G,30,30 Pro,30 RS, 20 Pro,20 RS,RS;
Xiaomi:12,12 Pro11,11 Pro,10,10 Pro,9,9Pro,Mix 3.Mix 2s;
Including other devices with wireless charging receiver built-in; other some devices need to add a wireless charging receiver (Note:All devices must meet the Qi standard).
- 2.Smart Watch:S3,S4,S5
Apple:Watch Ultra,Series 8,Nike,Hermes,SE,S7,S3.
- 3.TWS bluetooth earpho:
Apple AirPods 2,AirPods3,AirPods Pro.
Sam sung Galaxy Buds/Buds+/Buds Pro/Buds Live;
Huawei Freebuds 2/3/4i/Pro;and more TWS(with wireless charging case).

Product Specification

Input:9V/2.5A,12V/2A
Phone Output:15W/10W/7.5W/5W
Watch Output:2.5W
Earphone Output:5W
Input Interface:Type-C port
Transmission Distance(Phone):≤8mm
Charging Efficiency>75%
Product Size:163(L)X123(W)X20(H)mm

Packing List

Wireless Charger *1,Type-C quick charge cable*1, User manual*1

Notes

- 1.Please keep the charger away from water or other liquid
- 2.If you need to clean the charger ,please make sure it is not connected power supply
- 3.Working environment temperature: 0-45°C.
- 4.Charging environment temperature shall be <55°C (<131°F)

Troubleshooting

- 1.If you're experiencing interrupted or slow charging, check the following:
(1)The back of your phone should not have any metal, pop sockets, or credit cards.
(2)Put the phone in the center of the charging surface(this lets the charging coil in your phone line up with the one inside the wireless charger).
- (3)The wireless charging coil on Sony phones is located slightly below center.
- (4)Phone case thickness should be less than 5mm.
- (5)Check whether the adapter is QC2.0 or later version.

- 2.If you're failing to charge your device, please try out the following:
(1).Please restart your cellphone and test with other charge cable.
(2).Please check whether the indicator is on or not.
(3).Please check whether the adapter is QC2.0 or later version (Output:9V/2A).
Note:iPhone original adapter does not match the wireless charger.
(4).Please check your phone case thickness(<=5mm). Metal ring or magnetic pad shall be removed before
- 3.If the adapter is OK and you have removed any potential charging obstructions, but still have charge issues,try the following:
(1).Replace the charge cable.
(2).Reboot your phone.
(3).Unplug the adapter and re-plug it.

CE FC RoHS
Made in China

This device complies with part 15 of the FCC Rules. Operation is Subject To the following two conditions: (1) This device may not cause harmful interference, and (2) this device must accept any interference received, including interference that may cause undesired operation.

Caution: Any changes or modifications to this device not explicitly approved by manufacturer could void your authority to operate this equipment.

Note: this equipment has been tested and found to comply with the limits for a Class B digital device, pursuant to part 15 of the FCC Rules. These limits are designed to provide reasonable protection against harmful interference in a residential installation. This equipment generates, uses and candidate radio frequency energy and, if not installed and used in accordance with the instructions, may cause harmful interference to radio communications. However, there is no guarantee that interference will not occur in a particular installation. If this equipment does cause harmful interference to radio or television reception, which can be determined by turning the equipment off and on, the user is encouraged to try to correct the interference by one or more of the following measures:

- Reorient or relocate the receiving antenna.
- Increase the separation between the equipment and receiver.
- Connect the equipment into an outlet on a circuit different from that to which the receiver is connected.

The equipment complies with FCC radiation exposure limits set forth for an uncontrolled environment. During the operation of device a distance of 15 cm surrounding the device and 20 cm above the top surface of the device must be respected.