

Main Unit Diagram

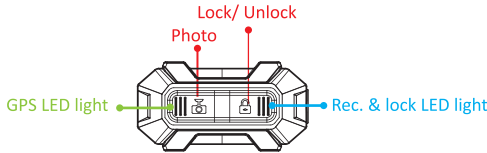
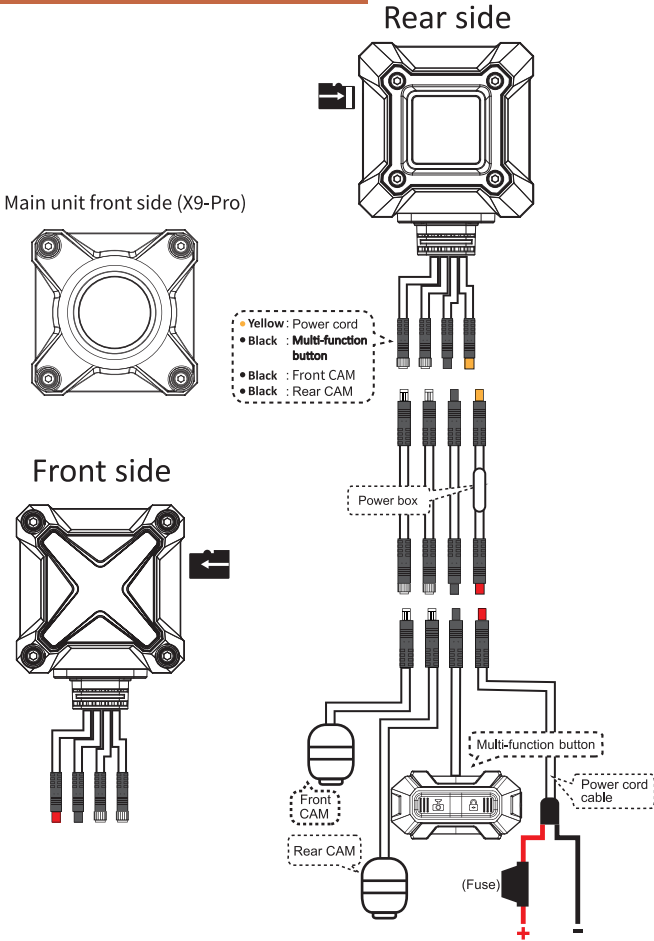

Multi-function GPS button explained:

- 1. During recording status / GPS no signal detected: GPS LED light: Slow flash 3sec. (On 3sec. /dim 3sec.) Recording & lock LED light: Slow flash 1sec. (On 1sec. / dim 1sec.)
- 2. During recording status / GPS signal detected: GPS LED light: Slow flash 1sec. (On 1sec. / dim 1sec.) Recording & lock LED light: Slow flash 1sec. (On 1sec. / dim 1sec.)
- 3. Short press = Recording & lock LED light will quick flash twice
- 4. Short press = Recording & lock LED light will quick flash
- 5. Long press for 10sec. & above = Enters SD card format, recording & lock LED will quick flash until format finishes
- 6. Not recording status = Recording & lock LED light will stay On

* Please Note:

Power cord cable

When connecting the camera to either an ignition switched Accessory connection or accessory controller. Please connect the red and black to the – terminals

During installation, please avoid high voltage, spark plugs, keyless etc. and make sure cables are flexible during turning cycles of bike

*User manual and accessories for reference only. Please refer to actual product

Lens/multi-function mounting suggestions

Mount lenses where they will give a clear view of the front and rear of the the bike

Using either “L” bracket or bolting directly to the lens mounting base

Mount Switch where it can be easily operated whilst riding & where it has clear line of sight to the sky as it has a built-in GPS in the Switch!

Camera Direction

Round Mark = Face Upward

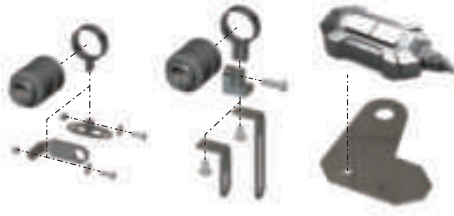
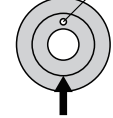

Specifications

Model	X9
Frame rate	30 fps
Lens aperture	F2.0
View angle	140°
Lens IP rating	IP67
Resolution	1920*1080
Memory card	Max. 128GB (C10)
WIFI	Support
Battery type	Button cell for time memory only
Video format	TS code (H.264)
Operating temp	-20°C ~ 70°C
Transmission	AHD
G-Sensor	Support : OFF / High / Medium / Low
Language	Simplified/Traditional Chinese, English,Japanese
Manufactured	Taiwan

FCC Information

This device complies with part 15 of the FCC Rules. Operation is subject to the following two conditions:
(1) This device may not cause harmful interference
(2) This device must accept any interference received, including interference that may cause undesired operation.

RF EXPOSURE WARNING

The antenna(s) used for this transmitter must be installed to provide a separation distance of at least 20 cm from all persons and must not be co-located or operating in conjunction with any other transmitter, except in accordance with FCC multi-transmitter product procedures.

APP Introduction

Step 1: Please download Global Eagle App using QR code



iOS



Android

Step 2: Open the App

Step 3: App start-up info.

Either press “Next” or top right corner “home” icon to exit

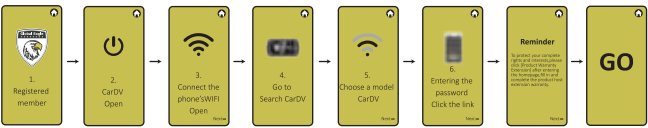

Step 4: Go to your mobile and under settings/Wi-Fi search for your dash camera

- ★ ID: GlobalEagle X9 _ x x x (Unique number for each dash camera)
- GlobalEagle X9 pro _ X X X
- ★ Default password: 12345678

Step 5: App main page, press top right corner “Live Video” button and search for driving recorder.

Once searched and connected successfully, you may now operate your dash camera with the App



*Note:

Memory card: For first time either new or used, please format before using otherwise your files cannot be saved or activated with App.

“Live video” are for emergency viewing as using Wi-Fi to view the files may be

unstable and slow, bigger the file size the longer it will take to upload onto your mobile.

For stable and best viewing, we suggest to download the files into your mobile.

Remarks

- 01. All new memory card must be formatted before using DVR, especially 64GB and above.
- 02. Please include warranty card with date of purchase and receipt when returning for warranty repair
- 03. Improper use or trying to disassemble the dash cam will void warranty.
- 04. Use only factory provided accessories such as cables/power cords. Use of non-factory accessories will void the warranty.
- 05. Please avoid high pressure washers directly on dash camera.
- 06. Memory cards have limited read and write life cycle. Please format every month for best performance and it is recommended to replace memory card every year to ensure files are 100% accessible.
- 07. Do not remove memory card while recording, otherwise file will be damaged.
- 08. Please make sure display no pressure is applied to DVR by other objects once installed.
- 09. Do not instantly power ON/OFF again, allow camera time to start up before turning off as this may cause the system to malfunction.
- 10. Do not use the dash camera in contravention to local law regulations for cameras.
- 11. Do not under any circumstances disassemble your dash cam otherwise warranty will be void.
- 12. Please keep camera lens clean for best image quality.
- 13. It is recommended to use GOM, KMP, POT, and MP4 to play recorded files.

WARNING

Changes or modifications to this unit not expressly approved by the party responsible for compliance could void the user’s authority to operate the equipment.
This equipment has been tested and found to comply with the limits for a Class B digital device, pursuant to part 15 of the FCC Rules. These limits are designed to provide reasonable protection against harmful interference in a residential installation. This equipment generates, uses and can radiate radio frequency energy and, if not installed and used in accordance with the instructions, may cause harmful interference to radio communications. However, there is no guarantee that interference will not occur in a particular installation. If this equipment does cause harmful interference to radio or television reception, which can be determined by turning the equipment off and on, the user is encouraged to try to correct the interference by one or more of the following measures:
—Reorient or relocate the receiving antenna.
—Increase the separation between the equipment and receiver.
—Connect the equipment into an outlet on a circuit different from that to which the receiver is connected.
—Consult the dealer or an experienced radio/TV technician for help.

APP Function Explained

Live Video

1.Open Live video

*Note: Press to return to previous page

Once App connection successfully, press “Open Live Video” to enter live video recording.



Stop recording



Snapshot



Switch between front and rear camera

2.Device Album

Video = “Video and emergency locked files” can be viewed

*Press the file you want to view and wait for it to be uploaded onto your mobile

Photo = “Photo” files can be viewed

*Press the file you want to view and wait for it to be uploaded onto your mobile

*Note :

To save files onto mobile, please long press the files you want to save and a pop-up information will allow you to either save/ delete/ return the selected files



Saving in progress



Save unsuccessfully please check Wi-Fi connection or restart App



Save successfully



Global Eagle/ 響尾蛇
YouTube



Global Eagle/ 響尾蛇
Facebook

Global Eagle

5F-5, No. 16, Ln.609, Sec. 5, Chongxin Rd.,
Sanchong Dist., New Taipei City 241
Taiwan

極佳電通股份有限公司 臺灣總公司
新北市三重區重新路五段609巷16號5樓之5



GlobalEagle
Website