

3.5in

14in

5in



**WARNING:**  
Contains coin battery

## ⚠ WARNING

- **INGESTION HAZARD:** This product contains a button cell or coin battery.
- **DEATH** or serious injury can occur if ingested.
- A swallowed button cell or coin battery can cause **Internal Chemical Burns** in as little as **2 hours**.
- **KEEP** new and used batteries **OUT OF REACH OF CHILDREN**
- **Seek immediate medical attention** if a battery is suspected to be swallowed or inserted inside any part of the body.



### ⚠ WARNING

- Remove and immediately recycle or dispose of used batteries according to local regulations and keep away from children. Do NOT dispose of batteries in household trash or incinerate.
- Even used batteries may cause severe injury or death.
- Call a local poison control center for treatment information.
- The alarm clock contains a CR2032 coin/button cell battery.
- The battery voltage is 3V.
- Non-rechargeable battery is not to be recharged.
- Do not force discharge, recharge, disassemble, heat above (manufacturer's specified temperature rating) or incinerate. Doing so may result in injury due to venting, leakage or explosion resulting in chemical burns.

#### Battery Warning:

- Ensure the batteries are installed correctly according to polarity (+ and -).
- Do not mix old and new batteries, different brands or types of batteries, such as alkaline, carbon-zinc, or rechargeable batteries.
- Remove and immediately recycle or dispose of batteries from equipment not used for an extended period of time according to local regulations.
- Always completely secure the battery compartment. If the battery compartment does not close securely, stop using the product, remove the batteries, and keep them away from children.

FCC ID: 2AO23-FM01 Model: PYS-BT24001 Made in Vietnam

This device complies with Part 15 of the FCC rules. Operation is subject to the following two conditions: 1) this device may not cause harmful interference, and 2) this device must accept any interference received, including interference that may cause undesired operation.  
Warning: Changes or modification to this unit not expressly approved by the party responsible for compliance could void the user's authority to operate the equipment.

NOTE: This equipment has been tested and found to comply with the limits for a Class B digital device, pursuant to Part 15 of the FCC Rules. These limits are designed to provide reasonable protection against harmful interference in a residential installation. This equipment generates, uses and can radiate radio frequency energy and, if not installed and used in accordance with the instructions, may cause harmful interference to radio communications.  
However, there is no guarantee that interference will not occur in a particular installation. If this equipment does cause harmful interference to radio or television reception, which can be determined by turning the equipment off and on, the user is encouraged to try to correct the interference by one or more of the following measures:

- Reorient or relocate the receiving antenna.
- Increase the separation between the equipment and receiver.
- Connect the equipment into an outlet on a circuit different from that to which the receiver is connected.
- Consult the dealer or an experienced radio/TV technician for help.

The device has been evaluated to meet general RF exposure requirements. The device can be used in portable exposure conditions without restriction.

For qualified repair specialists requesting repair information and parts please contact the original manufacturer at customersupport@gemsfindyours.com

Just what you need, priced just right.™  
100% Satisfaction Guaranteed or your Money Back.

🎯 We welcome any questions you may have at  
Target.com/comments or 1-800-910-6874.

deal  
worthy™

Instruction  
Manual

## Item Locator

### Package Contents

- Item Locator - 1

### Compatibility

- iOS or iPadOS 14.5 or newer

### Item Locator Setup Instructions

- Hold the power button for 5 seconds to power on/off, be sure to remove the protective film on the battery, the device will beep and the light will flash three times. Note: You can check if your device is on by clicking the button 2 times. If it beeps and the indicator light flash three times, then the device is on.
- To pair the device to your phone, open the Find My app.
- Make sure the device is close to your phone. Then click Items > Add Other Item.
- Once detected, click the tip 'Connect' and enter a name 'Locator'.
- Click on the tip 'Agree' to acknowledge that this item will be linked to your Apple ID and then the tap 'Finish'.

DO NOT PRINT

how to fold

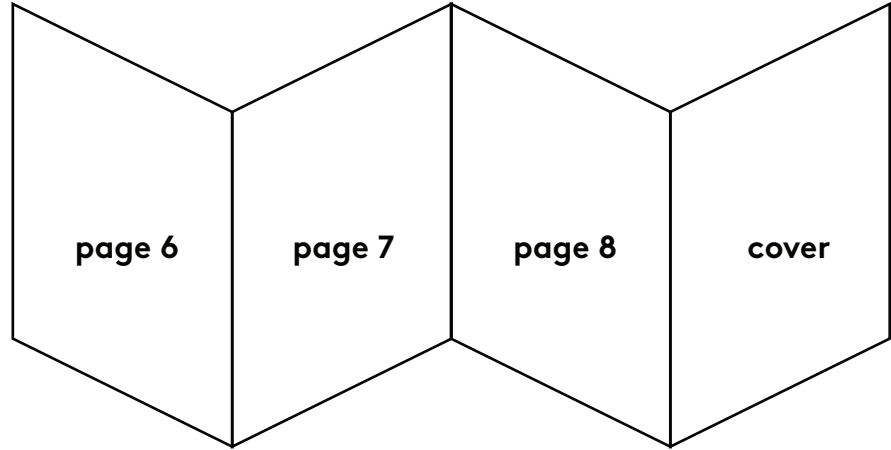

PAGE 6

PAGE 7

PAGE 8

COVER

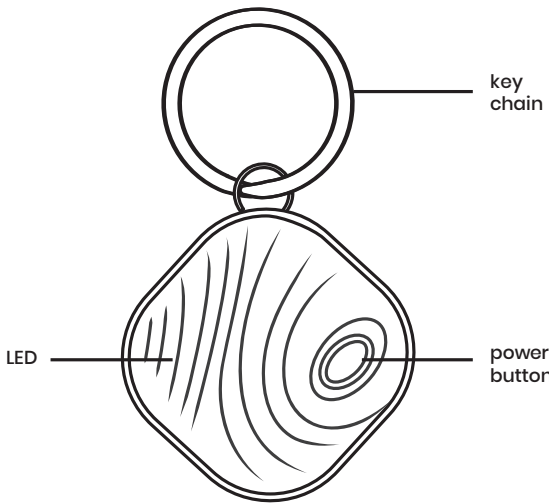

### Enabling Lost Mode

- Open the Find My app > Items > your item > Lost Mode > Enable.
- Read the instructions, tap 'Continue' and enter a phone number or email address.
- Confirm the information to complete the lost message, and tap 'Activate' to complete.

### Removing the Device

- Open the Find My app > Items > select your item > Remove Item > Remove.

Note: After removing the device in the app, the device will beep and the light will flash 6 times to re-enter pairing mode. To turn off the device, quickly press the button 5 times. If there is no re-pairing within 10 minutes, the device will leave pairing mode and you will need to re-enter pairing mode by pressing the button once. It will ring and flash once.

### Troubleshooting

- **IMPORTANT:** When pairing a device with the Find My app, the phone will link to the Apple Server. Pairing may fail because of network problems. The following actions are recommended:
- Change the phone's network, such as switching between Wi-Fi and mobile network.
- **Factory reset** for the device: When the device is powered on, double-click the device button. The device will beep, then immediately long press the device button for eight seconds until the device beeps and the light flashes three times. Release the button to complete the factory reset.

### Play Sound

- Open the Find My app > Items > select your item > Play Sound.

### Replacing the Battery

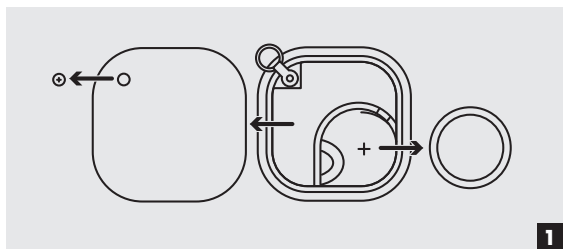

If the item locator is not working, you may need to replace the battery. Use a screwdriver to remove the screw and open the battery back cover and remove the old battery.

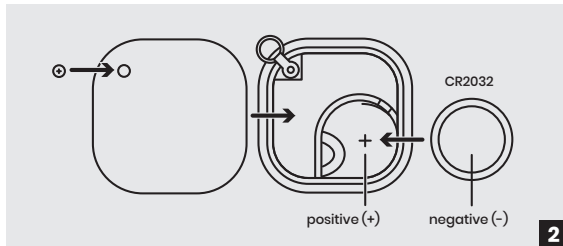

Insert the new battery in the proper direction as indicated by the positive (+) and negative (-) symbols and replace the battery back cover and tighten the screw.

### Safety:

WARNING When using this product, basic precautions should always be followed, including the following:

- Read all of the instructions before using the product
- To reduce the risk of injury, close supervision is necessary when the product is used near children
- Do not modify or repair this device
- Do not use in high temperatures or extreme weather
- Do not use chemical detergents to clean your device, use a soft dry cloth

PAGE 2

PAGE 3

PAGE 4

PAGE 5