

NOTES: (UNLESS OTHERWISE SPECIFIED)

- ANY ONE FAILURE OF TESTS INDICATED BELOW IS A FAILURE OF THE ENTIRE UNIT.
1. EACH BUTTON MUST PROPERLY FUNCTION AND COMMUNICATE WITH OPERATOR. ALL SEND COMMANDS MUST COMMUNICATE WITH 315MHz AND 390MHz FREQUENCIES.
  2. MUST MEET 500 FEET OPEN FIELD RANGE SPECIFICATIONS AT BOTH 315MHz AND 390MHz FREQUENCIES.
  3. VERIFY FIT IS VISUALLY ACCEPTABLE AND MEETS APPLICABLE GENIE COMPANY PRINTS.
  4. COSMETICS/VISUAL APPEARANCE:
    - A. COLOR TO MATCH PANTONES SPECIFIED ON PRINT.
    - B. NO MARKS, SCRATCHES OR IMPERFECTION OF ANY KIND AS JUDGED FROM A DISTANCE OF 18" UNDER FLUORESCENT LIGHTING.
  5. LABEL PLACEMENT:
    - A. CHECK FCC LABEL PER DRAWING.
    - B. FCC LABEL SHALL BE STRAIGHT AND CONSISTENT ON ALL UNITS.
    - C. INSTRUCTION LABEL SHALL BE STRAIGHT AND PLACED WITHOUT WRINKLES OR CREASES.
    - D. BAR CODE LABEL (1.25" x .5") TO BE ATTACHED TO BACK CASE AS SHOWN. LABEL SHALL BE STRAIGHT AND CONSISTENT ON ALL UNITS.
    - E. THE DATA ON THE BAR CODE LABEL WILL HAVE EIGHT CHARACTERS. THE FIRST SEVEN REPRESENTS THE SERIAL NUMBER AND THE LAST NUMBER REPRESENTS THE TRANSMITTER BUTTON FUNCTION CODE. THE BAR CODE TYPE WILL BE CODE 128.
  6. LOGO:
    - A. LOGO SHALL BE STRAIGHT AND CONSISTENT ON ALL UNITS.
    - B. LOGO SHALL BE READABLE.
  7. VERIFY UNIT IS BUILT TO PURCHASED REVISION.
  8. EACH UNIT MUST PASS FUNCTIONAL TEST.
  9. EACH UNIT MUST NOT BREAK WHILE CHANGING BATTERY AND EASILY BE REASSEMBLED.
  10. TAPE SCREWS, ITEM #9, IN THIS AREA OF THE COVER.

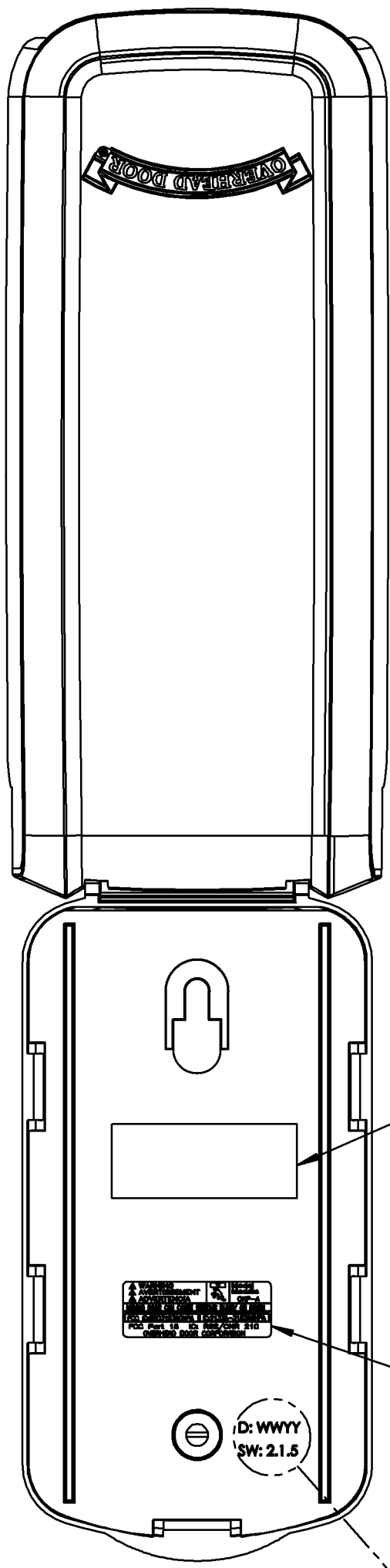
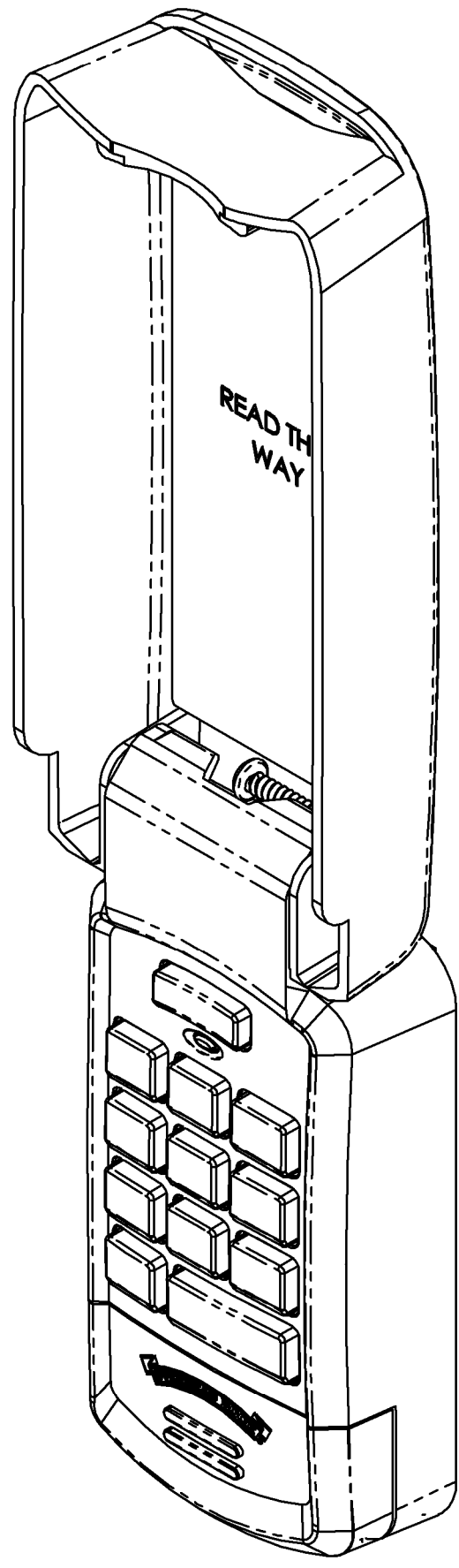
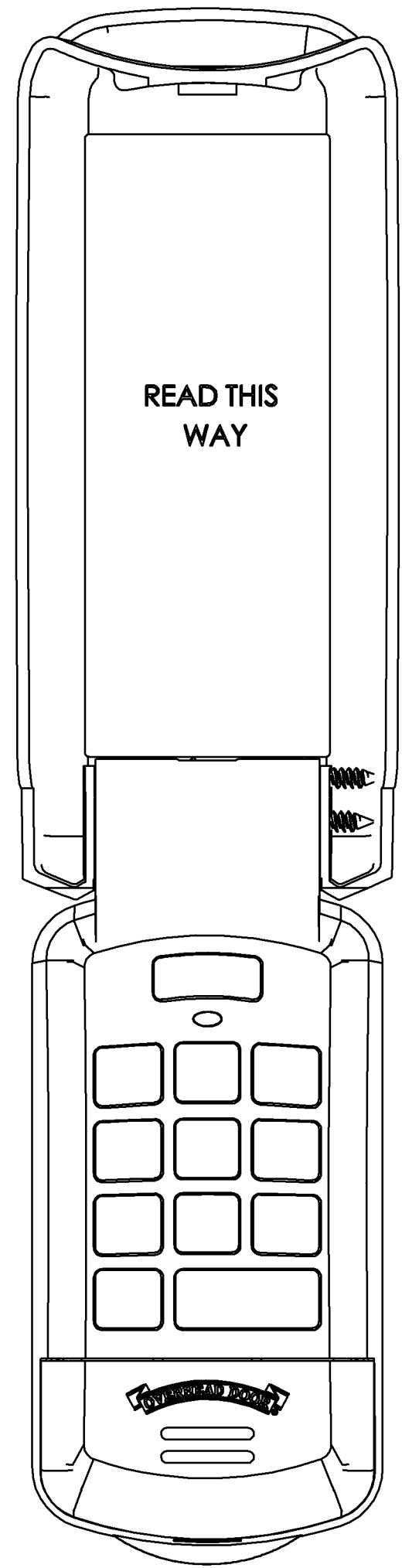

BAR CODE LABEL

D: WWYY  
SW: 2.1.5

DETAIL A  
SCALE 4 : 1

DATE CODE &  
SOFTWARE REVISION  
(ADDED DURING ASSEMBLY)

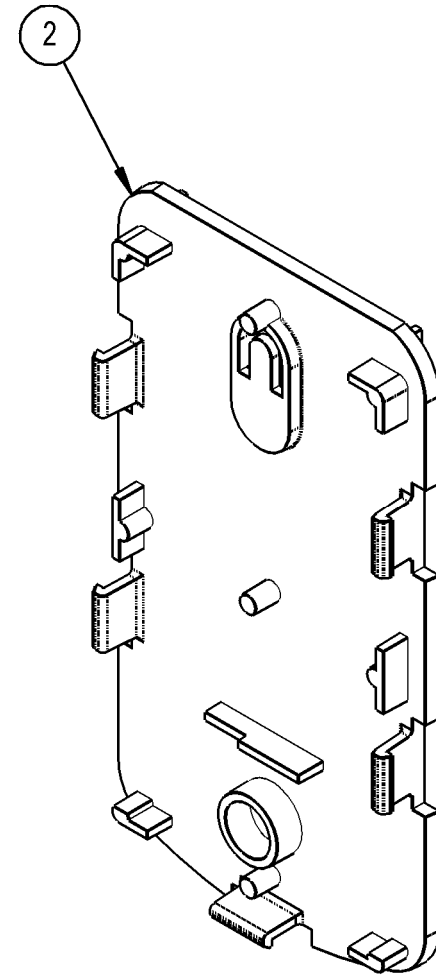
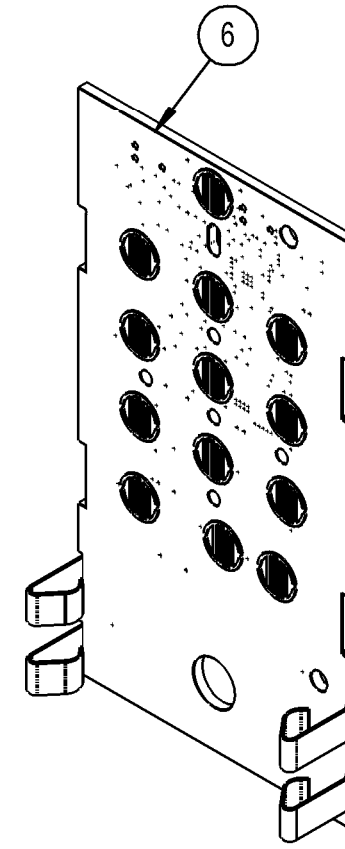
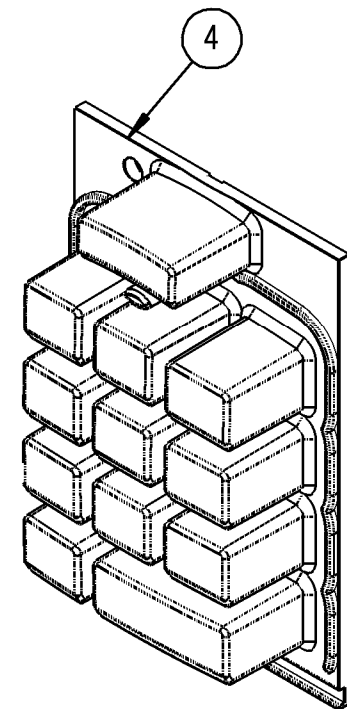
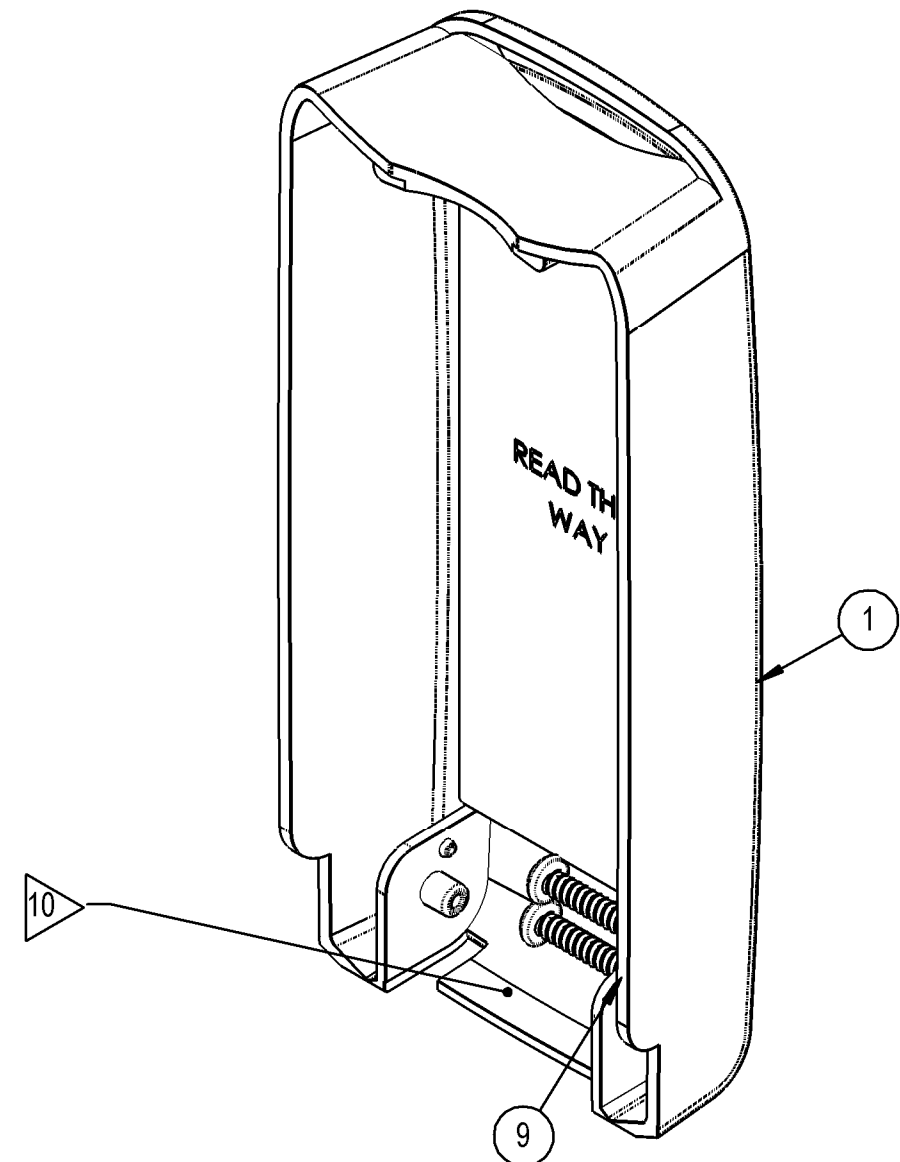

1	10	39260A	PULL TAB, UNIVERSAL
2	9	27490E04	SCREW, #6 x 1.25 PAN HD PHIL
1	8	38182B	LABEL, FCC/IC, WKPAD OKP-A, OHD
2	7	36863A	BATTERY, 1.5V, AAA
1	6	40877S	BD ASSY, WKPAD
1	5	36849B	COVER, BATTERY, WKPAD, OHD
1	4	36853A	KEYPAD, SILICONE
1	3	36852A	CASE, TOP, WKPAD
1	2	36851A	CASE, BACK, WKPAD
1	1	38365-R	COVER ASSY, WKPAD, OHD, WHITE
-R QTY	ITEM NO.	PART NO.	DESCRIPTION

BILL OF MATERIAL

PLOTTED: 1/30/17

THE DRAWINGS AND ALL OTHER INFORMATION CONTAINED HEREIN ARE THE CONFIDENTIAL, PROPRIETARY PROPERTY OF OVERHEAD DOOR CORPORATION, INCLUDING ITS AFFILIATED SUBSIDIARIES AND AFFILIATES. THIS DRAWING INFORMATION, IN WHOLE OR IN PART, MAY NOT BE COPIED IN ANY MANNER OR DISCLOSED TO ANYONE WITHOUT PRIOR WRITTEN CONSENT OF OVERHEAD DOOR CORPORATION. DISCLOSURE OF ANY DRAWING OR INFORMATION IS INTENDED NOT TO AND SHALL NOT OPERATE AS A LICENSE OR AUTHORIZATION TO USE IT FOR ANY PURPOSE WITHOUT SPECIFIC WRITTEN CONSENT OF OVERHEAD DOOR CORPORATION.

UNLESS OTHERWISE SPECIFIED

INTERPRET DIMS & TOLS PER ASME Y14.5M

ALL DIMS ARE IN INCHES

DO NOT SCALE

DIMS CIRCLED WITH SYMBOL 'C' ARE CRITICAL TO QUALITY DESIGN

FEATURES & MUST MEET APPLICABLE IN-PROCESS INSPECTION STANDARDS.

TOLERANCES:

X = ±.1

XX = ±.01

XXX = ±.005

ANGULAR = ±1°

HOLES:

< Ø.251 = ±.003

Ø.251-Ø.500 = ±.003

> Ø.500 = ±.003

APPROVALS DATE

DRAWN KMG 10/2/12

CHECKED DRU 10/3/12

APPROVED J.W. 10/3/12

MATERIAL

FINISH

ALL GEOMETRY GOVERNED BY 3D CAD DATABASE: 38362-MOD

DESCRIPTION

WKPAD ASSY, OHD

SIZE DWG NO.

D 38362

SCALE 1:1

SHEET 1 OF 1

REVISIONS

PRELIMINARY 01\_G

REPLACED P/N 38363-R WITH 40877S.

REPLACED P/N 38182A WITH 38182B.

SOFTWARE REVISION 2.1.5 WAS 1.0.10

05/05/2022

DATE

APPROVAL

J.W.

J.W.

J.W.

