

Know about this Smart Wi-Fi Plug

Voltage: 90~120V AC 60Hz

Max load current: 10A

Network: 2.4GHz

Transmit distance: within 20 meter (indoor use)

Control method: voice/app/button

Button : Smart plug on/off switch, Press and hold (for 5 seconds) until the green LED blinks to initiate the App-Config process.

Green LED:

Quick Blinking: App-Config mode initiated

Off: No network connection

On: Connected to the network

Red LED:

On: The Smart Plug is switched on.

Off: The Smart Plug is switched off.



This symbol is used to indicate safety instructions or to draw your attention to specific hazards and risks.

Don't use any heat-generating devices(such as electric blankets, coffee machines,etc.)with this product. There is a risk of fire and injury.

Don't use this product with any devices that are motorized or any devices that have a rotating component or workpiece. There is a risk of injury.

Risk of electric shock

This symbol indicates product parts energized with a dangerous voltage of sufficient magnitude to constitute a risk of electric shock.

Don't open the product. Don't continue to operate the product if it is damaged, Which may be indicated by smoke, odour or loud noises. Immediately contact your dealer.

Safety Notes

- The product is intended for indoor use only.
- Use the product for its intended purpose only.
- Children are not permitted to play with the device. Children may not clean the product or perform user maintenance without supervision.
- Protect the product from dirt, moisture and overheating, and only use it in a dry environment.
- Do not use the product in areas where the use of electronic devices is not permitted.
- The product may only be operated with the type of power supply network described on the name plate.
- Only connect the product to a socket that has been approved for the device. The socket must be installed close to the product and easily accessible.
- Do not drop the product and do not expose it to any major shocks.
- Do not operate the product outside the power limits given in the specifications.
- Do not modify the product in any way. Doing so voids the warranty.

Which system versions the APP supports

Android 4.4.2 and above are supported

IOS 8 and above are supported

Smart Wi-Fi Plug Installation

1. Prepare installation

1).Scan below QR code or search **Smart Life** from APP Store or Google Play and install the app, new user must register a account first.



2). Connect mobile device to your **2.4GHz Wi-Fi** router(with internet) and plug in the smart plug

2. Press the button for 5 seconds until the green LED fast blinks then run **Smart Life** app add device(select All→ Electrical outlet) and follow the in-app instructions to connect the smart plug to your network .

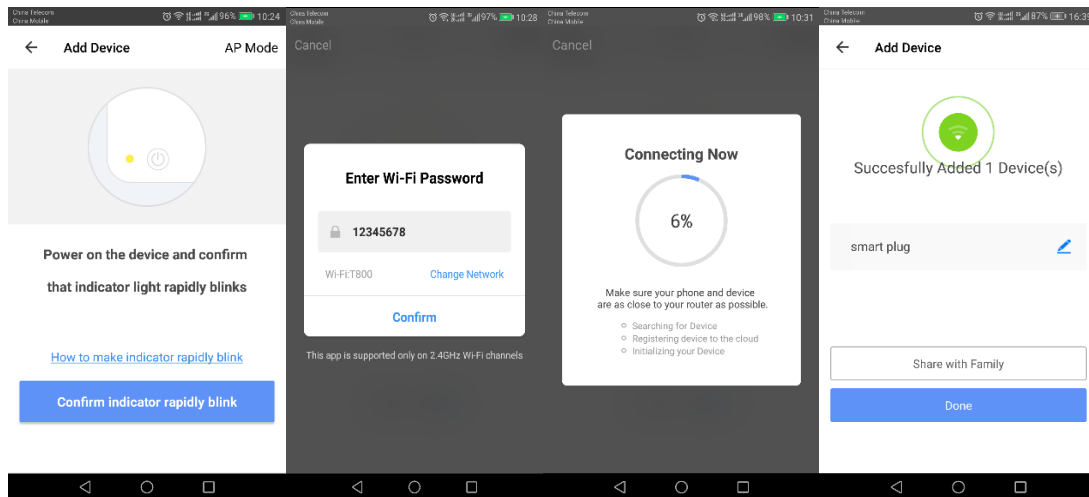

3. Control the smart plug with **Smart Life** app

3.1 For switch on/off, left time, time as below:

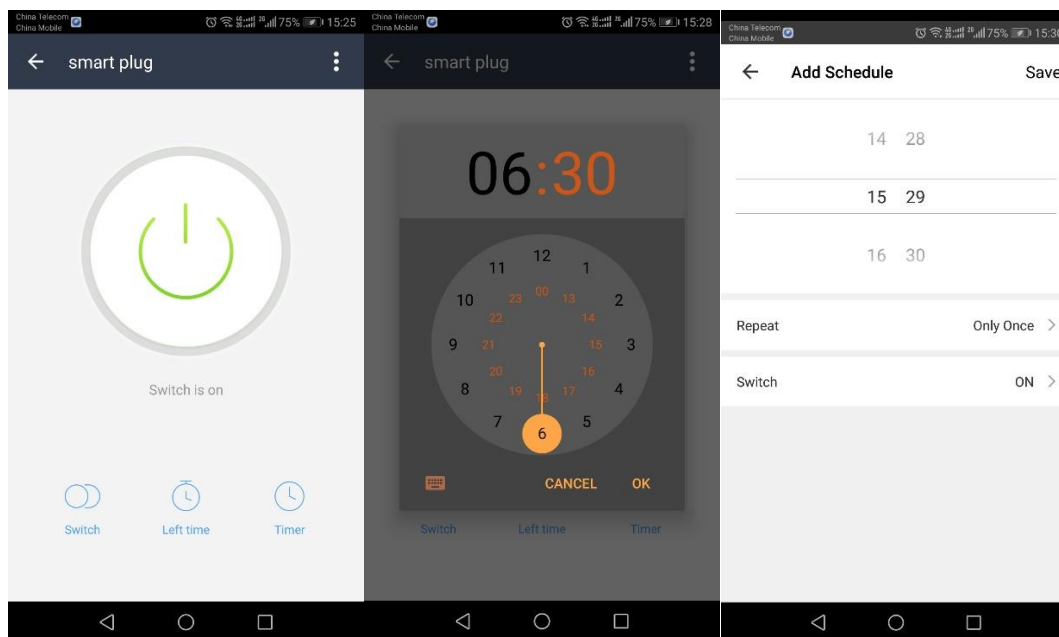

3.2 Modify device name

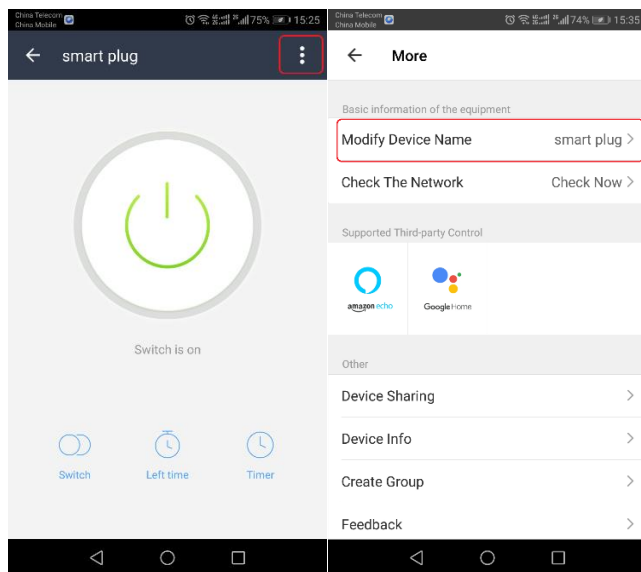

3.3 Device Sharing

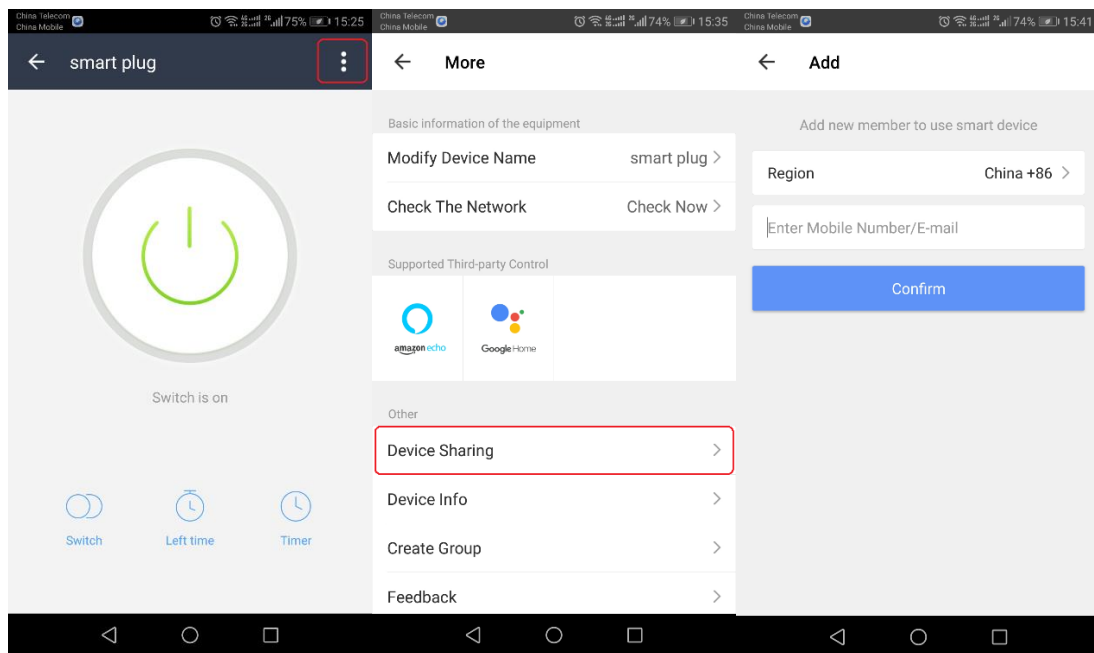

3.4 Remove device

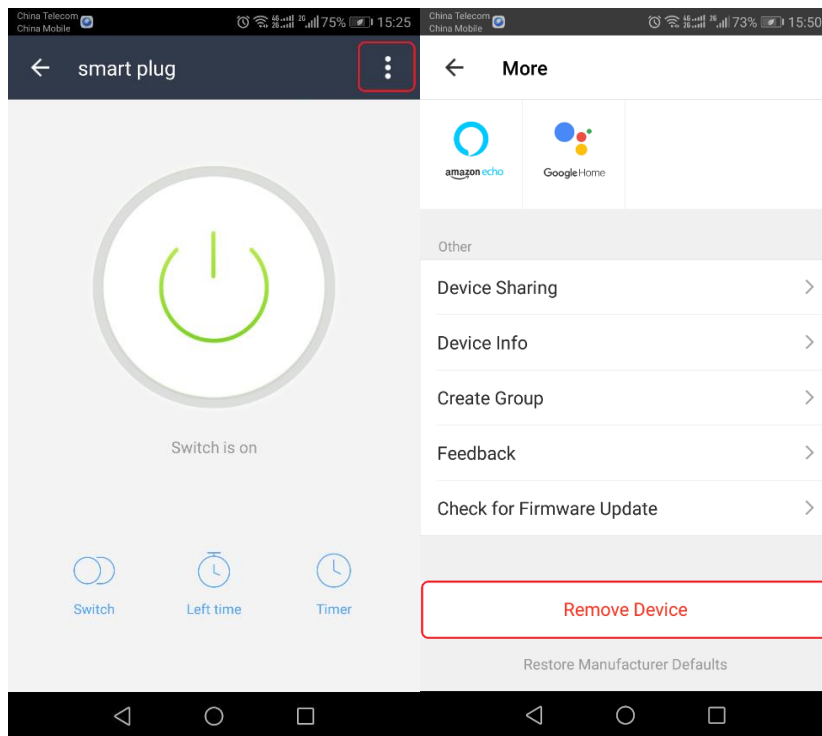

3.5 Create Group

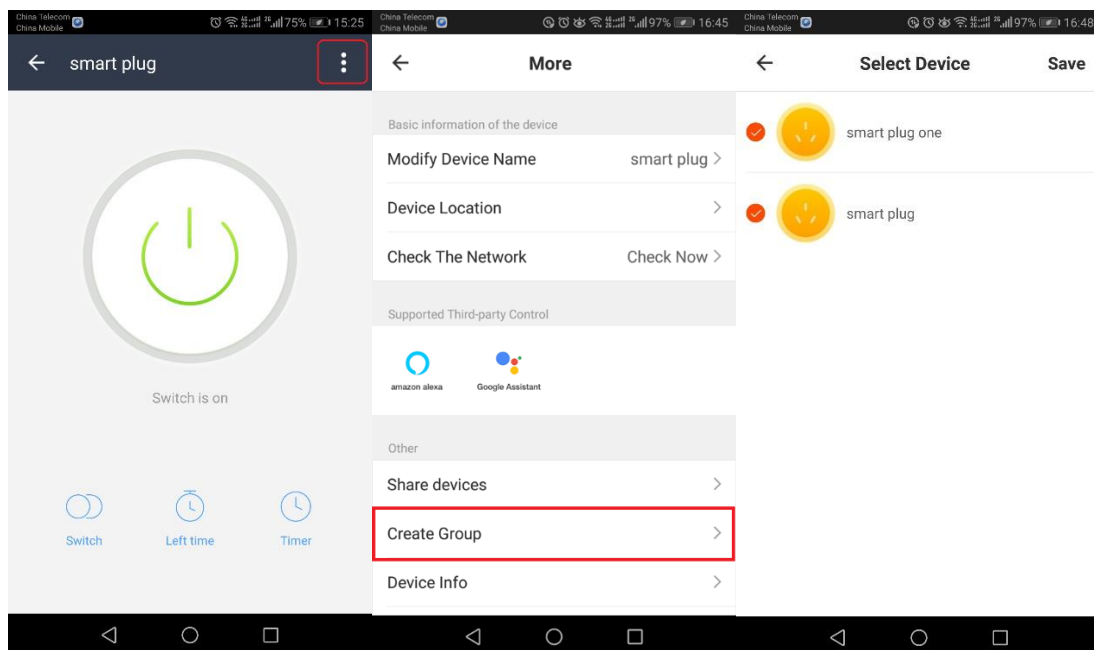

Note: the group can't be control by alexa and google home.

3.6 Smart Scenes settings

Open **Smart Life** app and click **Smart Scenes**→**Add Scene**,you can select Scene or

Autmation as below:

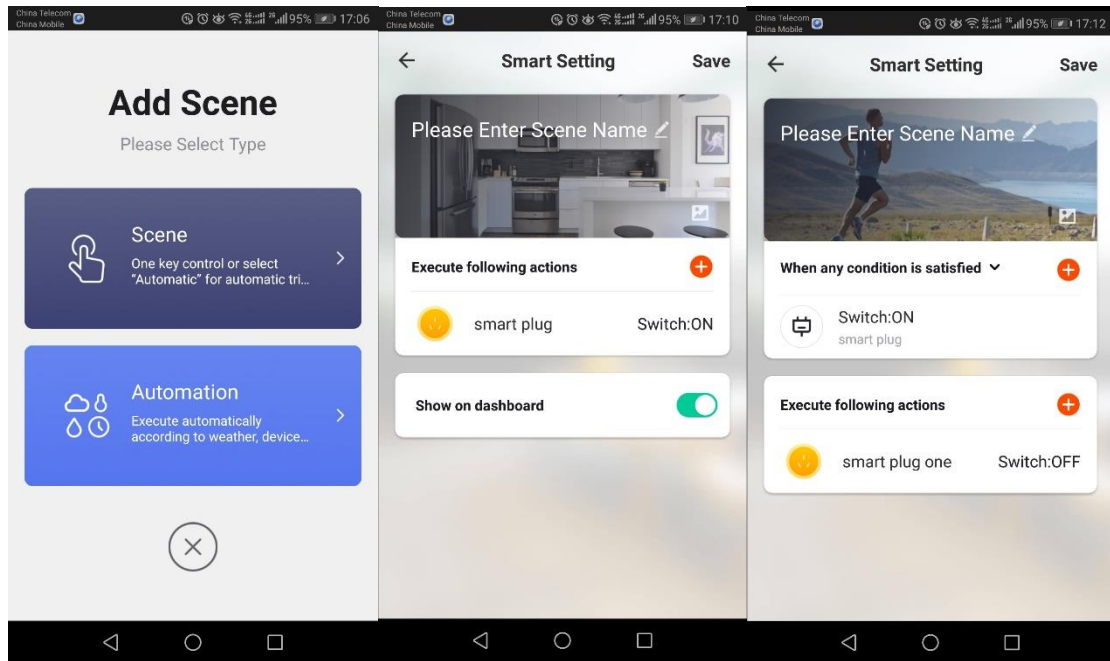

4. if you want to control the smart plug with amazon echo or Google home please open [Smart Life](#) app and click [Profile](#)→[Settings](#)→[Integration](#) enter the guide.

4.1 How to connect your device to Amazon Alexa

Step 1 : Add Device

Make sure there is at least 1 device that is supported by Amazon Alexa. This is shown on the Integration Screen.

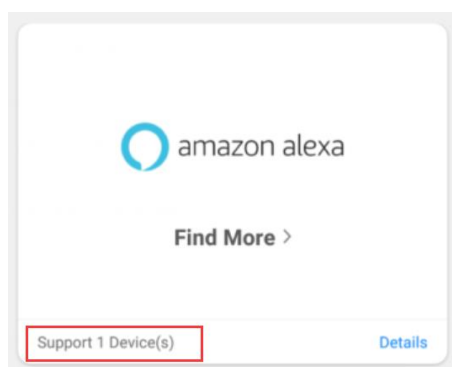

Step 2 : Modify Device Name

Modify device name so your Amazon Alexa can easily recognize the name. For Example:

Living Room Lamp, Bedroom Light.

Step 3 : Set Up Alexa

Use Alexa App or Computer (<http://alexa.amazon.com>) to set up your Amazon Alexa.

Step 4 : Add Skill

In the menu bar, go to “Skills” and search for "Smart Life". Enable Skill, then type in your login info from your app account to finish the account linking.

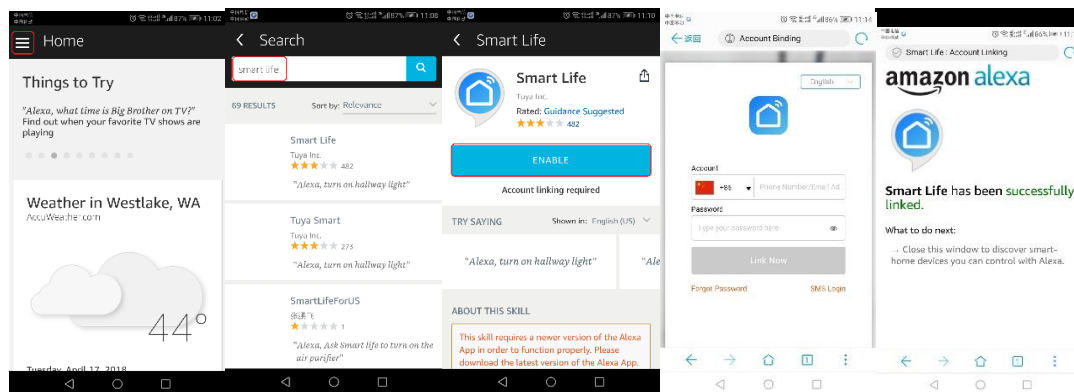

Step 5 : Control Device

Ask Alexa to discover devices. After 20 seconds, devices will be discovered and Alexa will tell you “ I found x devices”. Then you can control your devices using voice through your Amazon Alexa product.

The following voice commands are supported:

Alexa, turn on the plug.

Alexa, turn off the plug.

4.2 How to control your device via Google Home

Step 1 : Add Device

Make sure there is at least 1 device that is supported by Google Home. This is shown on the Integration Screen.

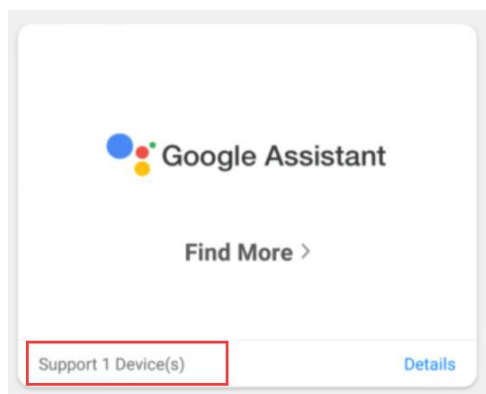

Step 2 : Modify Device Name

Modify device name so your Google Home can easily recognize the name. For Example:
Living Room Lamp, Bedroom Light.

Step 3 : Set up Google Home

Make sure phone system language is set to English. Then use the Google Home app to set up your Google Home.

Step 4 : Add Home Control Action

In the menu bar, go to "Home Control" to add devices. Select "Smart Life", then type in your login info from your app account to finish the account linking. Your device should now

be listed in the Home Control device list.

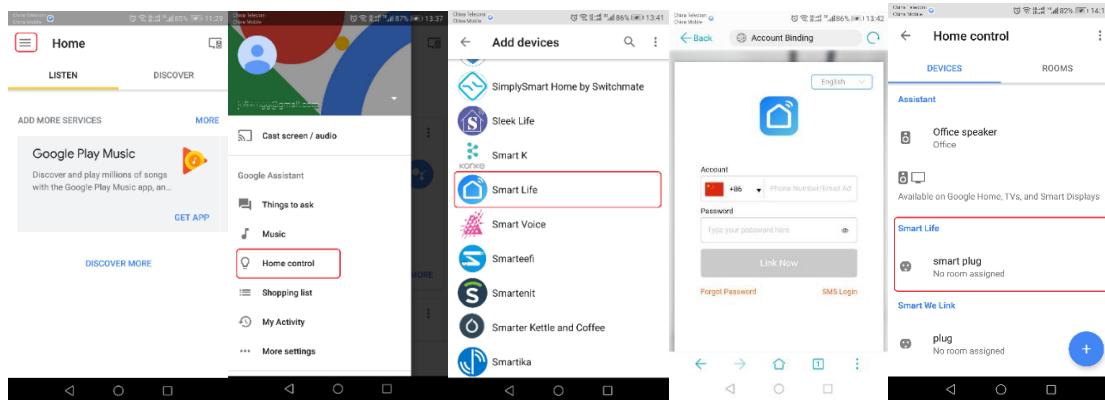

Step 5 : Control Device

You can now control your devices using voice through your Google Home product.

The following voice commands are supported:

Ok Google, turn on the plug.

Ok Google, turn off the plug.

Note on environmental protection:



After the implementation of the European Directive 2012/19/EU and 2006/66/EU in the national legal system, the following applies: Electric and electronic devices as well as batteries must not be disposed of with household waste. Consumers are obliged by law to return electrical and electronic devices as well as batteries at the end of their service lives to the public collecting points set up for this purpose or point of sale. Details to this are defined by the national law of the respective country.

FCC Warning

This device complies with part 15 of the FCC rules. Operation is subject to the following two conditions: (1) this device may not cause harmful interference, and (2) this device must accept any interference received, including interference that may cause undesired operation.

Changes or modifications not expressly approved by the party responsible for compliance could void the user's authority to operate the equipment.

NOTE: This equipment has been tested and found to comply with the limits for a Class B digital device, pursuant to part 15 of the FCC Rules. These limits are designed to provide reasonable protection against harmful interference in a residential installation. This equipment generates uses and can radiate radio frequency energy and, if not installed and used in accordance with the instructions, may cause harmful interference to radio communications. However, there is no guarantee that interference will not occur in a particular installation. If this equipment does cause harmful interference to radio or television reception, which can be determined by turning the equipment off and on, the user is encouraged to try to correct the interference by one or more of the following measures:

- Reorient or relocate the receiving antenna.
- Increase the separation between the equipment and receiver.
- Connect the equipment into an outlet on a circuit different from that to which the

receiver is connected.

- Consult the dealer or an experienced radio/TV technician for help.

Radiation Exposure Statement

This equipment complies with FCC radiation exposure limits set forth for an uncontrolled environment. This equipment should be installed and operated with minimum distance 20cm between the radiator and your body.