

中文

TWS-H01



感谢您购买和使用本产品!
为了您带来更好的使用体验, 请仔细阅读说明书

产品参数

产品名称	双耳蓝牙耳机
型号/蓝牙名称	H01
材质	ABS+PC
蓝牙传输距离	10M
蓝牙版本	5.0
净重	≈ 98g
移动电源容量	2000mAh
耳机电池容量	45mAh*2
输入	5V=1A
传输频率	(2400-2483.5) MHz

1

产品概况

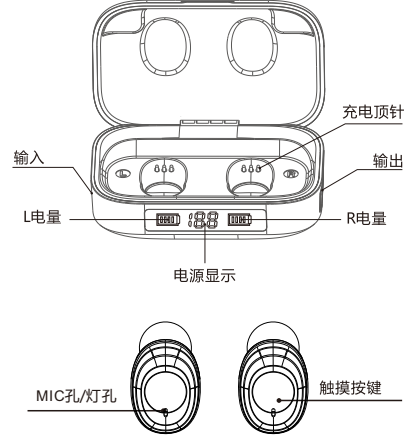

温馨提示

由于耳机是触摸式操作模式，在取出耳机的过程中手指尽量不要碰到耳机中间触摸点。如果不小心手指按在触摸点上引起耳机自动关机时候，请把耳机放回充电仓重新取出使用。耳机在不放入充电仓的情况下需要关机的话请长按触摸点，闪几下红灯后耳机关机，需要开机的话长按触摸点闪蓝光即是开机状态。

2

使用说明

1. 使用产品前请把耳机放入充电舱，充电半小时后再使用。
2. 打开充电舱拿起耳机，耳机自动开机配对，进入搜索模式。
3. 打开手机蓝牙设备，点击H01链接即可。
4. 当耳机与手机断开链接，耳机5分钟后自动关机！

防水说明

由于本产品是触摸式操作。当耳机掉入水中时候，由于水接触到触摸按键，耳机会自动关机。在水里一段时间后，水珠会进入喇叭孔部位，建议甩一下水珠并且放入充电仓过几小时，等水分充分挥发耳机才会恢复正常。

按键功能说明

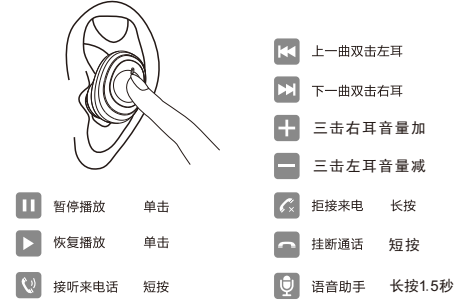

3

耳机功能：

功能	按键	音频	LED
耳机充电模式	n/a		红灯长亮
耳机充满电模式	n/a		转蓝灯后10秒熄灭
断开蓝牙待机模式	n/a	连接中断 Disconnected	左声道进入红蓝灯交替闪烁搜索状态
配对状态待机模式	n/a		红蓝灯交替闪烁
低电量模式	n/a	低于3V3, 电量不足, 请充电 (Low Battery)	隔3秒, 红灯快闪1次 (250MS)
进入配对模式	从充电仓拿起自动配对	进入配对模式 (Paring mode)	红蓝灯交替闪烁
耳机之间配对成功	n/a	已连接 (di Paring mode)	右耳灯灭左耳进入红蓝灯交替闪烁
来电	n/a	n/a	蓝灯间隔3秒快闪5次
连接手机蓝牙	n/a	connection successful	主耳蓝灯慢闪右耳进入红蓝灯交替闪烁

4

充电使用说明

1. 给耳机充电时，红色指示灯常亮，充电完成后指示红灯熄灭，蓝灯长亮10秒后熄灭。(注：红灯没有亮起，说明耳机电头没有接触好，请重新摆放)
2. 给电池盒充电时，电池盒显示屏数字慢闪，充满后电池盒显示屏长亮，移除充电线显示屏关闭。

低电量提醒说明

1. 耳机电量不足时，红色指示灯闪烁并有语音提示；
2. 耳机电量耗尽后会自动关机。

常见问题及解决方法

1. 连接无线播放音乐没声音
手机断开无线耳机之后再连接
耳机放进充电仓后再拿出来连接手机无线
对手机音量键进行调节音量
2. 无法TWS配对
非法操作会导致耳机无法进入TWS配对
耳机关机再开机进行操作
耳机手动开机，长按摸耳机到红蓝灯交替闪烁手，三击耳机触摸按键，红灯闪三次即自动关机，此操作为清除记忆操作（注意：两个耳机都要进行此操作）。再次打开耳机连接即可。
3. 通话质量差
离开wifi密集地方再通话，因为无线和wifi同时在2.4GHz频段上工作会有互相干扰。
通话时，没戴耳机方把手机通话音量开大。
通话时，戴耳机方把耳机跟手机的距离调短点。
耳机电量太低会影响通话质量。

5

配件清单



注意事项

1. 切勿使用具有腐蚀性的清洁剂清洁本产品。
2. 如果长时间不使用本产品，请将耳机放入电池盒内储存，并确保储存环境干燥，并每月至少给电池盒充电一次。
3. 使用本产品请将系统音量调整至适中，长时间音量过大导致听力受损的风险。
4. 禁止拆解、撞击、抗压或投入火中，若出现鼓胀，请勿继续使用，请置于高温环境中。

6

TWS-H01

English



Thank you for purchasing and using this product
please read this instruction of use carefully as to bring you better experience of use.

Product Specification:

Product Name	TWS Bluetooth Headset
Model/Bluetooth Name	H01
Material	ABS+PC
Bluetooth Transmission Range	10m
Bluetooth Version	5.0
Net Weight	≈ 98g
Charging case capacity	2000mAh
Earbuds Battery Capacity	45mAh*2
Input	5V=1A
Transmission Frequency	(2400-2483.5)MHz

1

Product Overview:

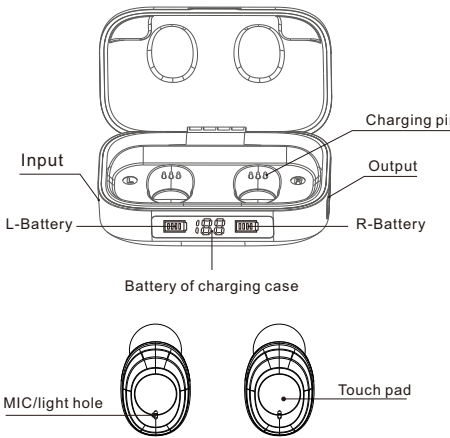

Warm reminder

As the earbud is a touch mode of operation, fingers should not touch the touch point in the middle of the earbuds when removing the earbuds. please put the earbuds back into the charging case and take it out again if shut down automatically caused by the wrong press on the touch point, please press the touch point for a long time to power off the earbuds without Putting them into the charging case, it is done after red light flash several times. If want to power on them again, just press the touch point for a long time until the blue light flash

2

Instruction of use

1. Please put the earbuds into the charging case and charge 30 minutes before start when receive our product
2. The earbuds are turning on and pairing automatically after open the charging box and pick them up
3. Search "H01" and connect after turn on the bluetooth function in your devices
4. The earbuds would be powered off automatically in 5 minutes after disconnection from the mobile devices

Waterproof instruction

As this product is a touch mode of operation, the headsets are off automatically in the water as a press on the touch point by water. the water will go inside through the speaker holes after a while, a suggestion of throw away the water first and then put into the charging case for charging for few hours, the moisture will take time to volatile and then the headsets work as normal again

Touch Function instruction

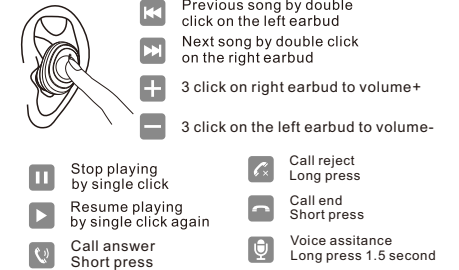

3

Earbudsfunctions

Functions	Key	Audio	Led
Earbuds charging mode	n/a		Red light long on
Earbuds full charge mode	n/a		Go out in 10 second after turning blue light
Standby mode of Bluetooth disconnect	n/a	Disconnect	The left earbud enters the searching mode of red and blue light flashing alternately
Standby mode of pairing status	n/a		Red and blue light flashing alternately
Low battery mode	n/a	Low Battery, please charge	Red light quick flash once every 3 second
Enter pairing mode	Paring automatically after pick up from charging case	Enter pairing mode	Red and blue light flashing alternately
Successful pairing	n/a	Connected	The right earbud enters the searching mode of red and blue light flashing alternately
Income call	n/a	n/a	Blue light flashing 5 times every 3 second
Connect wireless to mobile devices	n/a	Connected	Blue light of master earbud slow flash and then enter the status of red and blue light flashing alternately

4

Charging instruction

1. The red light is always on when charging the earphones, and if full charge, the red light is off, and then blue light light up for 10 seconds until off (Noted: the charging pins should be not in good contact if the red light is not on, please pick up the earphones and put them them back again)
2. The digits in the display screen flash slowly when the charging bix is charging, the display screen is always on when the charging box is fully charged, the light is turned off when the charging cable is removed.

Low battery reminder

1. The red light indicator is flashing with voice prompt when the earphones are in low battery condition.
2. The earphones are turned off automatically when the earphones run out of battery.

Common problems and Solutions

1. Play music but no sound after connect to wireless
A, Re-connect to mobile phone after disconnection.
B, Put them back to the charging case and pick up to re-connect.
C, Adjust the phone volume by the volume key.
2. Unable to pair TWS
Illegal operation will cause headphones to fail to access TWS pairings
The solution is to Turn off the headset and turn on again
Here is the instruction of operation: Turn off the earbuds manually
A long press on the touch point until the red and blue lights flashing alternately, and then 3 short click on the touch point of earbuds, it would power off automatically when red light flash 3 times, this is called memory-clearing operation. (note: this operation need to be made on both of the earbuds), finally, we just need to power on the earbuds again for re-connect.
3. Poor quality of calls
Leave the WIFI intensive area and call again, because it might cause the interfere when wireless and wifi work on the same frequency band of 2.4Ghz at the same time
When talking, the side without headset need to turn the voice louder
When talking, the side with headsets need to shorten the distance between headsets and mobile phones.
low Headphone battery will cause poor quality of calls.

5

Accessories

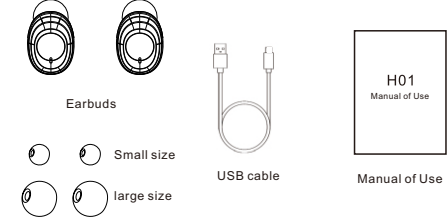

Warning

1. Do not use corrosive detrgent to clean this product.
2. If you do not intend to use this product for a long period of time, Please put the headsets back into the portable charging case, store it in a dry environment and charge the headsets at least once a month to prolong its life.
3. Please turn to the modest volume to avoid noise and damage hearing.
4. Do not disassemble, trike, squeeze or put into fire. Once it is bulging, do not continue to use. Do not put it in high temperature environment.

6

英文

FCC Warning Statement

Changes or modifications not expressly approved by the party responsible for compliance could void the user's authority to operate the equipment. This equipment has been tested and found to comply with the limits for a Class B digital device, pursuant to Part 15 of the FCC Rules. These limits are designed to provide reasonable protection against harmful interference in a residential installation. This equipment generates uses and can radiate radio frequency energy and, if not installed and used in accordance with the instructions, may cause harmful interference to radio communications. However, there is no guarantee that interference will not occur in a particular installation. If this equipment does cause harmful interference to radio or television reception, which can be determined by turning the equipment off and on, the user is encouraged to try to correct the interference by one or more of the following measures:

- Reorient or relocate the receiving antenna.
- Increase the separation between the equipment and receiver.
- Connect the equipment into an outlet on a circuit different from that to which the receiver is connected.
- Consult the dealer or an experienced radio/TV technician for help.

This device complies with part 15 of the FCC Rules. Operation is subject to the following two conditions: (1) This device may not cause harmful interference, and (2) this device must accept any interference received, including interference that may cause undesired operation.