

User Manual

SPECIFICATION

Model: LA-RC04

Remote control socket

Voltage: 125VAC, 60Hz

Max.load: 15A Resistive or General purpose, 10A/1250W Tungsten, 1/2HP

Remote

battery: 1PC CR2032 3V

Radio frequency: 433.92MHz

Operation distance: about 80 feet in open area.

For indoor use only.

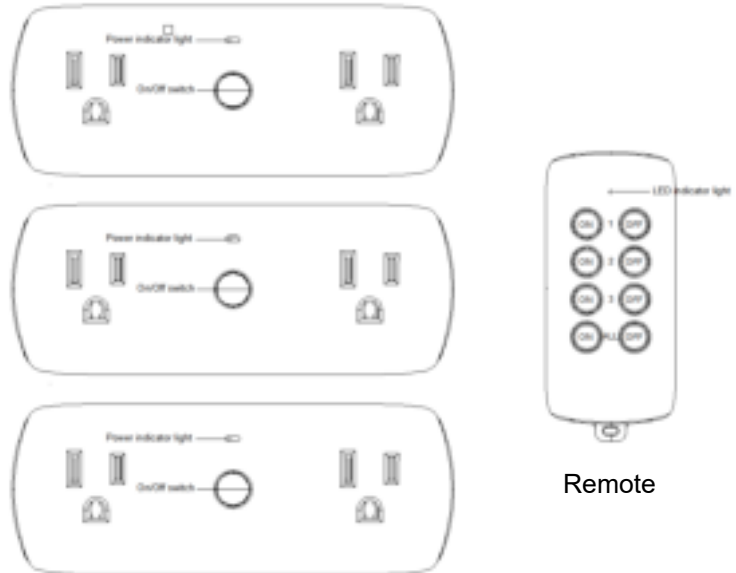

Remote control socket

OPERATION

1. Put battery in the remote.

Open battery cover of the remote and put 1PC CR2032 3V battery in it. Then press button of remote once to check whether it can work. If LED indicator turns on, it means this remote works well.

2. Plug the timer into a GFCI protected receptacle. Press the remote control socket ON/OFF switch, and the power indicator light will light up.

3. Pairing with remote (remote function)

a. Press hold ON/OFF Switch for at least 5 seconds, Power indicator light of the Remote Control Socket is slowly flash. Enter into learning mode. (Please note: The timer will exit learning mode after 20 seconds without any operation).

b. Press ON button of the remote once to pair with the timer. Once successfully, LED indicator of the timer stops flash and keeps on.

c. Now you can turn on/off Remote Control Socket.

Power indicator light of the timer turns on, it means power is on. In contrast, power is off.

4. Clear the pairing

a. Press hold ON/OFF Switch for at least 5 seconds, Power indicator light of the Remote Control Socket is slowly flash, Enter into learning mode.

Please note: The timer will exit learning mode after 20 seconds without any operation.

b. Press On/Off switch of the Remote Control Socket once to clear the pairing. Once successfully, LED indicator of the Remote Control Socket stop flashing.

WARNINGS

Risk of Electric Shock

- Keep children away.
- Do not plug two or more timers together.
- Always ensure the plug of any appliance is fully inserted into the timer outlet.
- If cleaning of the timer is required, remove from mains power and wipe timer with a dry cloth.
- Do not immerse timer in water or any other liquid.

Risk of Fire

- Don't plug in an appliance where the load exceeds rated capacity.

- Do not use with extension cords.
- Do not use to control appliances that contain heating elements (cooking appliances, heaters, irons, etc.).

CAUTION:

Any changes or modifications not expressly approved by the party responsible for compliance could void the user's authority to operate the equipment.

This device complies with Part 15 of the FCC Rules. Operation is subject to the following two conditions: (1) this device may not cause harmful interference, and (2) this device must accept any interference received, including interference that may cause undesired operation.

This equipment has been tested and found to comply with the limits for a Class B digital device, pursuant to part 15 of the FCC Rules. These limits are designed to provide reasonable protection against harmful interference in a residential installation. This equipment generates uses and can radiate radio frequency energy and, if not installed and used in accordance with the instructions, may cause harmful interference to radio communications. However, there is no guarantee that interference will not occur in a particular installation. If this equipment does cause harmful interference to radio or television reception, which can be determined by turning the equipment off and on, the user is encouraged to try to correct the interference by one or more of the following measures:

- Reorient or relocate the receiving antenna.
- Increase the separation between the equipment and receiver.
- Connect the equipment into an outlet on a circuit different from that to which the receiver is connected.
- Consult the dealer or an experienced radio/TV technician for help.

The device has been evaluated to meet general RF exposure requirement. The device can be used in portable exposure condition without restriction.

ISED RSS Warning:

This device complies with Innovation, Science and Economic Development Canada licence-exempt RSS standard(s).

Operation is subject to the following two conditions: (1) this device may not cause interference, and (2) this device must accept any interference, including interference that may cause undesired operation of the device.

Cet appareil est conforme à la ou aux normes RSS exemptées de licence pour Innovation, Science et développement économique Canada. Le fonctionnement est soumis aux deux conditions suivantes: (1) ce dispositif ne peut pas causer d'interférence nocive, et (2) ce dispositif doit accepter toute interférence reçue, y compris les interférences pouvant causer un fonctionnement indésirable.

This equipment complies with ISED radiation exposure limits set forth for an uncontrolled environment. The device has been evaluated to meet general RF exposure requirement.

Ce matériel est conforme aux limites d'exposition aux rayonnements établies pour un environnement non contrôlé. L'appareil a été évalué pour répondre aux exigences générales d'exposition aux RF.