

Wireless live streaming earphone set

User manual



Product Introduction

Thank you for choosing our company's product:
This product is a wireless live streaming headphone set that does not require connection to other devices and can be worn on the ear. You can live stream karaoke anytime, anywhere on the device.
The wireless live streaming headphone set consists of three parts: receiver, remote control, and wireless Earphones.
(As shown in the following figure)

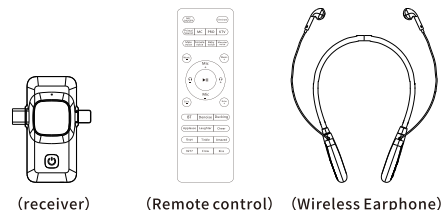

Function Introduction

(1) Receiver Function Introduction

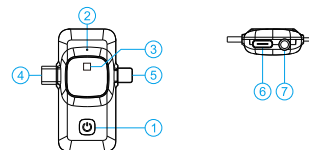

Attention: The receiver does not have a built-in battery and needs to be connected to a power source or mobile phone for use

1. Pairing button: This product is already paired when it leaves the factory, and it can be automatically paired upon startup. If no automatic pairing is successful, please manually pair. Pairing method: Turn on the receiver, then turn on the wireless earphones, and continuously hit the receiver three times. Wait for a moment for the pairing button and three consecutive taps of the headphone power button to pair successfully.
2. Pairing indicator light: The power on indicator light flashes, and the successfully paired indicator light remains on for a long time.
3. Power on indicator light: The power on indicator light is always on.
4. Type-C connector: Connect to the Type-C connector on an Android phone.
5. Lightning plug: Connect to the iPhone Lightning plug.
6. Type-c power socket: Provides power to the receiver through an adapter.
7. 3.5mm live streaming jack: Connect the phone to a 3.5 mm audio cable via a 3.5mm plug, using a 3.5mm jack. Live streaming through the mm socket requires simultaneous connection to a power supply through the charging port.

Function Introduction

(2) Introduction to Remote Control Functions

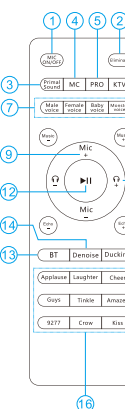

1. On/off microphone: Turn on/off the headphone microphone function.
2. Original cancellation: Turn on/off the original cancellation function.
3. Original sound: preset mode.
4. Shout: preset mode.
5. Professional: Pre set mode.
6. KTV: preset mode.
7. Voice change: Short press to switch between different voice change modes.
8. Accompaniment: Adjust the volume of the accompaniment.
9. Microphone: Adjust the volume of the microphone.
10. Monitoring: Adjust the listening volume.
11. Reverb: Adjust the volume of the reverb.
12. Play/Pause: Bluetooth accompaniment can be operated.
13. Bluetooth: Turn Bluetooth function on/off.
14. Noise reduction: Turn on/off the noise reduction function.
15. Dodge: Turn on/off the dodge function.
16. Special effects sound: Contains 9 types of special effects sound, short press to play.

Function Introduction

(3) Introduction to wireless headphone functions

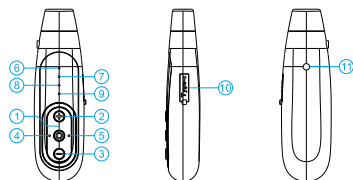

1. Power button: Long press to turn on/off, short press to turn on/off the microphone function.
2. Volume+: Short press to increase headphone volume, long press to turn Bluetooth function on/off.
3. Volume -: Short press to decrease the volume of the headphones, long press to turn on/off the dodge function.
4. Pairing indicator light: Flashing when turned on, always on if pairing is successful.
5. Bluetooth indicator light: Flashes when turned on, Bluetooth connection is always on, Bluetooth function light is off when turned off.
6. Charging indicator light: Low battery flashing, constantly on during charging, fully charged light off.
7. Mode indicator light: The indicator light goes off in the original sound mode, but remains on in other modes.
8. Microphone indicator light: Turn on the microphone light and turn off the microphone light.
9. Power on indicator light: Always on when turned on.
10. Type-C jack: A charging jack that can charge headphones.
11. Microphone: Built in microphone.

Usage

(1) Type-C socket phone usage method and schematic diagram

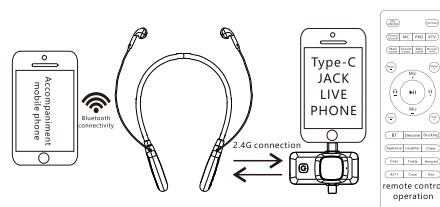

- Step 1: First, connect the receiver to the live streaming phone through the Type-C plug.
- Step 2: Long press the wireless headphone power button to turn on the device, and wait for the headphone to automatically pair with the receiver. Success.
- Step 3: Open the live streaming app on your mobile phone to start live streaming.
- Step 4: Accompaniment Connection: Open the accompaniment phone Bluetooth and search for the Bluetooth name "E8" to connect. After successful connection, the accompaniment can be played through the accompaniment phone.
- Step 5: Perform various adjustment operations through the remote control.

Usage

(2) Usage and diagram of Lightning mobile phone

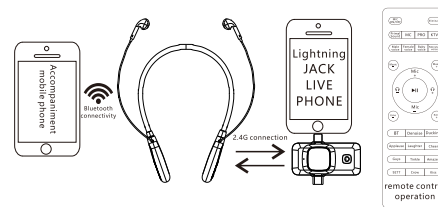

- Step 1: First, connect the receiver to the live streaming phone through the Lightning plug.
- Step 2: Long press the wireless headphone power button to turn on the device, and wait for the headphone to automatically pair with the receiver. Success.
- Step 3: Open the live streaming app on your mobile phone to start live streaming.
- Step 4: Accompaniment Connection: Open the accompaniment phone Bluetooth and search for the Bluetooth name "E8" to connect. After successful connection, the accompaniment can be played through the accompaniment phone.
- Step 5: Perform various adjustment operations through the remote control.

Usage

(3) Usage and schematic diagram of 3.5mm socket mobile phone

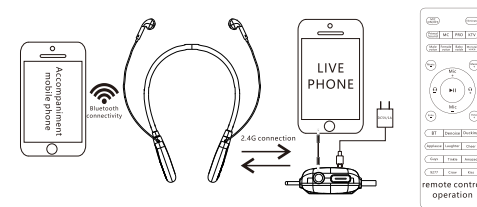

- Step 1: First, connect the receiver to the live streaming phone and receiver through a 3.5 audio cable.
- Step 2: Connect the receiver and power adapter through a charging cable to power the receiver.
- Step 3: Long press the wireless headphone power button to turn on the device, and wait for the headphone to automatically pair with the receiver. Success.
- Step 4: Open the live streaming app on your mobile phone to start live streaming.
- Step 5: Accompaniment Connection: Open the accompaniment phone Bluetooth and search for the Bluetooth name "E8" to connect. After successful connection, the accompaniment can be played through the accompaniment phone.
- Step 6: Perform various adjustment operations through the remote control.

This device complies with part 15 of the FCC Rules. Operation is subject to the following two conditions: (1) this device may not cause harmful interference, and (2) this device must accept any interference received, including interference that may cause undesired operation.

Any changes or modifications not expressly approved by the party responsible for compliance could void the user's authority to operate the equipment.

NOTE: This equipment has been tested and found to comply with the limits for a Class B digital device, pursuant to Part 15 of the FCC Rules. These limits are designed to provide reasonable protection against harmful interference in a residential installation. This equipment generates, uses and can radiate radio frequency energy and, if not installed and used in accordance with the instructions, may cause harmful interference to radio communications. However, there is no guarantee that interference will not occur in a particular installation.

If this equipment does cause harmful interference to radio or television reception,

which can be determined by turning the equipment off and on, the user is encouraged to try to correct the interference by one or more of the following measures:

- Reorient or relocate the receiving antenna.
- Increase the separation between the equipment and receiver.
- Connect the equipment into an outlet on a circuit different from that to which the receiver is connected.
- Consult the dealer or an experienced radio/TV technician for help.

The device has been evaluated to meet general RF exposure requirement. The device can be used in portable exposure condition without restriction