



Before You Begin...

CAUTION

- **THIS IS NOT A TOY, Please keep away from children**
- Keep away from water and extreme temperatures
- Low power may cause poor Bluetooth connection or sound distortion
- **Do not overcharge the battery**
- Do not insert objects into the charging ports of the earbuds or into the charging case
- Only use the charging case to charge ARBT10 earbuds, do not try to charge any other wireless earbuds with the supplied charging case.

Questions & Customer Support

For further assistance or any troubleshooting, visit our website at **SouthernTelecom.com** and click on **Product Support**.

In the Box

- ARBT10 - **True Wireless Earbuds** (x1)
- Charging Case (x1)
- Micro-USB Charging Cable (x1)
- User Manual (x1)

Location of Controls

1. [Multi] Button:
(Long Press) Power ON/OFF
(Double Quick Press) Redial last phone number
(Quick Press) Pause/resume playback, Answer/end phone call
2. Earbud LED Indicator
3. Case-Charging LED Indicator
4. Earbud-Charging LED Indicator
5. [⏻] Button: Enable/disable earbud charging
6. Micro-USB Charging Port

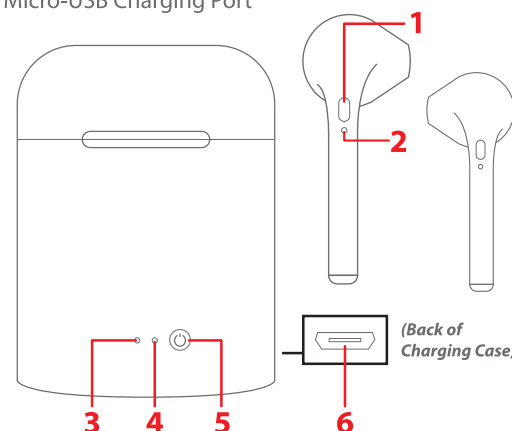

Using the Earbuds

Charging the Case

Insert the small connector of the supplied micro-USB cable into the port on the back of the charging case. Insert the large connector into the USB port on a computer, USB charging device, or **5V USB adapter** (not included) and plug into a wall socket.

The case-charging LED indicator will **flash RED** while charging and turn off when fully charged.

Charging the Earbuds

Make sure the charging case is fully charged.

Open the charging case and insert the stem of each earbud into the case's charging port. Gently press down until they "clip" into place and feel secure.

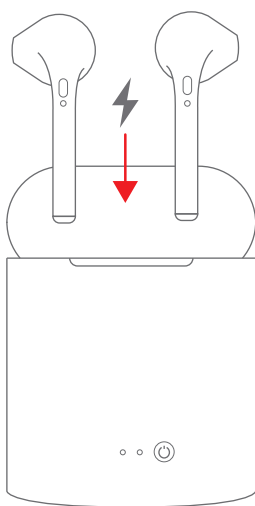

Press the [⏻] button to enable charging. The earbud-charging LED indicator will **turn RED** while charging and **turn BLUE** when fully charged.

Powering ON/OFF

- Turn the earbuds ON/OFF by long pressing the [Multi] button. A tone will be heard, indicating that the earbuds are powered ON.
- The earbuds will automatically enter Bluetooth pairing mode.

Bluetooth Pairing

1. Long press the [Multi] button on both earbuds until their LED indicators **flash RED and BLUE**.
2. After a moment, a voice will be heard on the earbuds indicating that they are connected. The LED indicators on both earbuds will **slowly flash BLUE**.
3. Set your mobile device to search for Bluetooth devices. When it appears, select **ARBT10** from the list of found devices.
4. Once successfully paired, the LED indicators on each earbud will continue to **slowly flash BLUE**.



If a previously paired device is in range when the earbuds are turned on, they will reconnect to it automatically.

On iOS and Android Devices

- Go to **Settings** -> **Bluetooth**

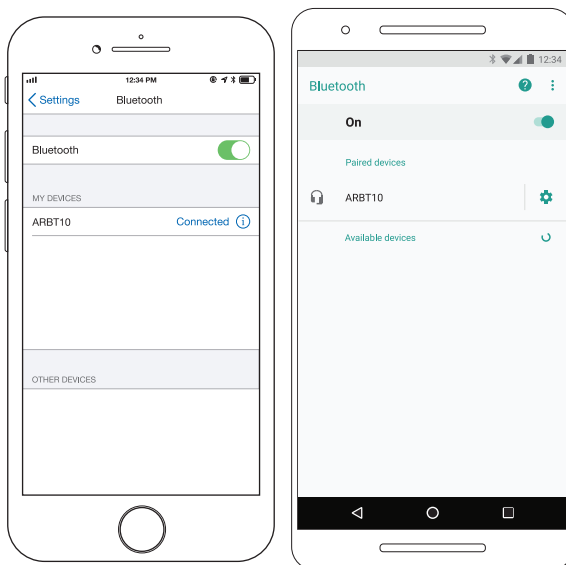

The screenshots above are typical of many Bluetooth-enabled devices in the market today, and are used to assist in the explanation of the pairing process. Your Bluetooth-enabled device's interface and interaction with the device may differ slightly from the illustrations above.

Re-Pairing the Earbuds

The **ARBT10** earbuds come automatically paired to each other right out of the box. If the earbuds come un-paired from each other, they will need to be re-paired.

If your earbuds become un-paired, follow these instructions to re-pair them:

1. Long press the [Multi] button of both earbuds at the same time, until the LED indicators **flash RED and BLUE**.
2. Quick press the [Multi] button on either earbud. After a moment, the LED indicators will **slowly flash BLUE** and the two earbuds will re-pair to each other.
3. Once re-paired, you can now pair the earbuds to your mobile device. Please consult the **Bluetooth Pairing** section of this user manual.

Playing Music

To enjoy music wirelessly on your earbuds, make sure they are properly paired to your Bluetooth-enabled device. Once paired, playback is controlled through your paired device.

If you are pairing the device for the first time, please consult the **Bluetooth Pairing** section in the previous column.

Pause/Resume Music

- Quick press the [Multi] button on either earbud to pause media playback.
- Quick press the [Multi] button on either earbud to resume media playback.

Answering/Ending Phone Calls

NOTE: Phone calls will only be heard on one earbud.

- Quick press the [Multi] button to answer an incoming phone call.
- Quick press the [Multi] button to end a phone call.
- Double quick press the [Multi] button to redial the last incoming phone number or phone number called.

READ CAREFULLY AND KEEP THIS MANUAL

Note: This equipment has been tested and found to comply with the limits for a Class B digital device, pursuant to part 15 of the FCC Rules. These limits are designed to provide reasonable protection against harmful interference in a residential installation. This equipment generates, uses and can radiate radio frequency energy and, if not installed and used in accordance with the instructions, may cause harmful interference to radio communications. However, there is no guarantee that interference will not occur in a particular installation. If this equipment does cause harmful interference to radio or television reception, which can be determined by turning the equipment off and on, the user is encouraged to try to correct the interference by one or more of the following measures:

- Reorient or relocate the receiving antenna.
- Increase the separation between the equipment and receiver.
- Connect the equipment into an outlet on a circuit different from that to which the receiver is connected.
- Consult the dealer or an experienced radio/TV technician for help.

Caution: Any changes or modifications not expressly approved could void the user's authority to operate the equipment.

This device complies with Part 15 of the FCC Rules. Operation is subject to the following two conditions: (1) This device may not cause harmful interference, and (2) this device must accept any interference received, including interference that may cause undersired operation.

The device has been evaluated to meet general RF exposure requirement. The device can be used in portable exposure condition without restriction.

WARNING Li-ion Battery Inside

This product is fitted with a Li-ion battery. Do not damage, open, or dismantle the battery and do not use it in damp and/or corrosive conditions. Use only with compatible chargers. Never dispose of batteries in a fire, and never expose them to high temperatures. Do not expose the product to temperatures exceeding 60°C (140°F).



Rain/Moisture Warning

- Do not expose the unit to extreme temperatures (heat or cold), open flames, humid conditions, or wet conditions.
- Do not submerge in water.
- Do not open this product or attempt to repair the unit yourself should it not be working.

	Rating Label Definitions Direct current
	Comply with Waste Electrical and Electronic Equipment (WEEE) Directive (2012/19/EU)
	The product is in compliance of energy efficiency.

Bluetooth

This symbol indicates that information could be exchanged between wireless devices such as personal digital assistants (PDAs), mobile phones, laptops, computers, printers and digital cameras via a secure, low-cost, globally available short-range radio frequency band. The Bluetooth word mark and logos are owned by Bluetooth SIG, Inc.

90 Days Limited Warranty

In the unlikely event that this product is defective, or does not perform properly, you may within ninety (90) days from your original date of purchase return it to the authorized service center for repair or exchange.

TO OBTAIN WARRANTY SERVICE:

- Go to our website portal to receive an SRO number.
- Provide proof of the date of purchase within the package (dated bill of sale).
- Prepay all shipping costs to the authorized service center, and remember to insure your return.
- Include a return shipping address (no P.O. Boxes), a telephone contact number, and the defective unit within the package.
- Describe the defect or reason you are returning the product.

Your product will be repaired or replaced, at our option, for the same or similar model of equal value if examination by the service center determines this product is defective. Products received damaged as a result of shipping will require you to file a claim with the carrier.

The shipping address of the authorized service center is:

 **Customer Service Dept. 36**
c/o Southern Telecom
400 Kennedy Drive
Sayreville NJ 08872

Should have any questions or problems concerning this product, please visit our website:

 **SouthernTelecom.com**
Click on **Product Support**

Warranty Service Not Provided

This warranty does not cover damage resulting from accident, misuse, abuse, improper installation or operation, lack of reasonable care, and unauthorized modification. This warranty is voided in the event any unauthorized person opens, alters or repairs this product. All products being returned to the authorized service center for repair must be suitably packaged.

Limitation of Warranty

- THE WARRANTY STATED ABOVE IS THE ONLY WARRANTY APPLICABLE TO THIS PRODUCT. ALL OTHER WARRANTIES, EXPRESS OR IMPLIED (INCLUDING ALL IMPLIED WARRANTIES OF MERCHANTABILITY OR FITNESS FOR A PARTICULAR PURPOSE) ARE HEREBY DISCLAIMED. NO VERBAL OR WRITTEN INFORMATION GIVEN BY AIT, INC. ITS AGENTS, OR EMPLOYEES SHALL CREATE A GUARANTY OR IN ANY WAY INCREASE THE SCOPE OF THIS WARRANTY.
- REPAIR OR REPLACEMENT AS PROVIDED UNDER THIS WARRANTY IS THE EXCLUSIVE REMEDY OF THE CONSUMER. AIT, INC. SHALL NOT BE LIABLE FOR INCIDENTAL OR CONSEQUENTIAL DAMAGES RESULTING FROM THE USE OF THIS PRODUCT OR ARISING OUT OF ANY BREACH OF ANY EXPRESS OR IMPLIED WARRANTY ON THIS PRODUCT. THIS DISCLAIMER OF WARRANTIES AND LIMITED WARRANTY ARE GOVERNED BY THE LAWS OF THE STATE OF NEW YORK. EXCEPT TO THE EXTENT PROHIBITED BY APPLICABLE LAW, ANY IMPLIED WARRANTY OF MERCHANTABILITY OR FITNESS FOR A PARTICULAR PURPOSE ON THIS PRODUCT IS LIMITED TO THE APPLICABLE WARRANTY PERIOD SET FORTH ABOVE.

Some states do not allow the exclusion nor limitation of incidental or consequential damages, or limitations on how long an implied warranty lasts so the above limitations on exclusions may not apply to you. This warranty gives you specific legal rights, and you also may have other rights that vary from state to state.