

JCHR35W3C3/C4/C5

Hand-held LCD Remote Controller

User Manual

01 Product Info

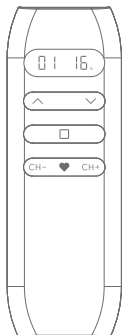

JCHR35W3C3
Application:Roller shade

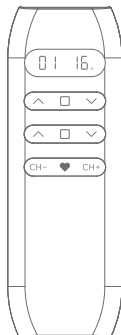

JCHR35W3C4
Application:Roller shade

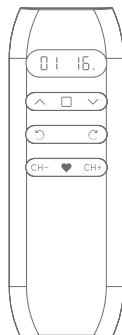

JCHR35W3C5
Application:Venetian blind

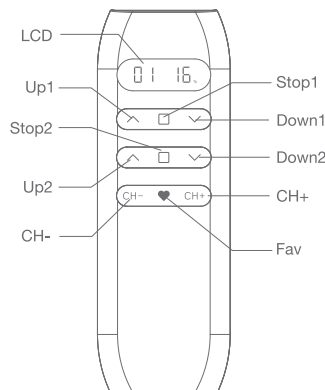

JCHR35W3C4
16-channel dual control LCD
remote controller

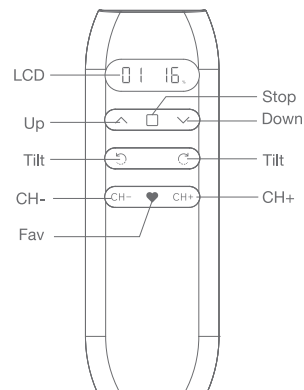

JCHR35W3C5
16-channel LCD
remote controller

02 Buttons

a. Front

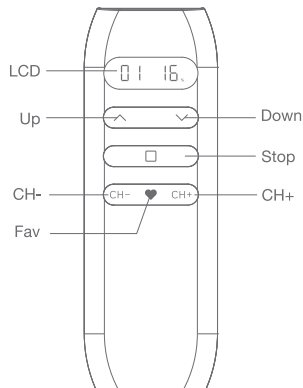

JCHR35W3C3
16-channel LCD
remote controller

b. Back

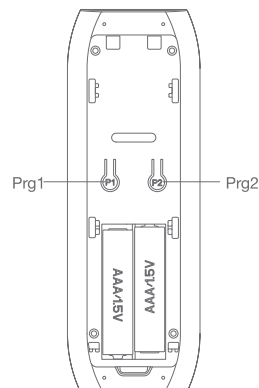

03 Parameters(more info please refer to the nameplate)

Electrical Specification	Standard
Battery Type	AAA battery*2
Working Temperature	-10℃-50℃
Radio Frequency	433.92M±100KHz
Transmit Distance	>=30m indoor

04 Caution!



- 1.The transmitter should not be exposed to moisture or impact, so as not to affect its life
- 2.During use, when the remote control distance is significantly shorter or less sensitive, please check whether the battery needs to be replaced.
- 3.When the voltage is too low, the LCD screen digital display will be weak, prompting to replace the battery.
- 4.Please properly dispose of used batteries according to the local garbage classification and recycling policy.

05 Instructions

a.Channels & Groups Toggling

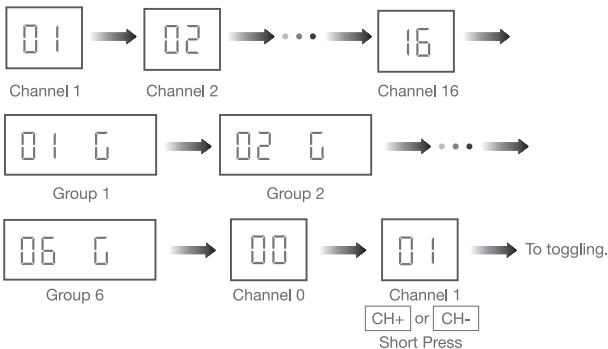

Note: Channel 0 is the group control for all the channels.

b.Number of Channels Setting

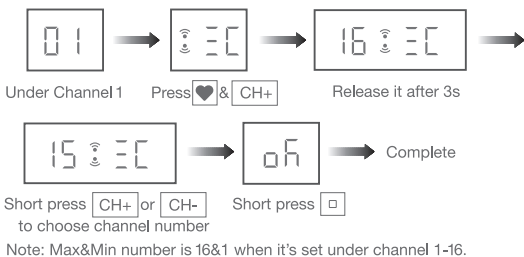

c.Number of Groups Setting

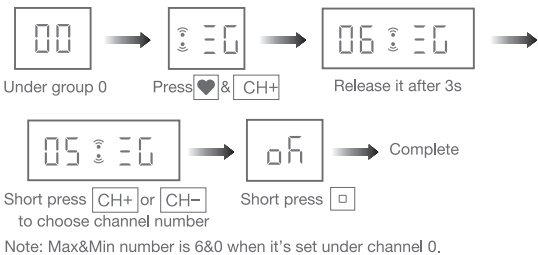

d.Channel in Group Setting

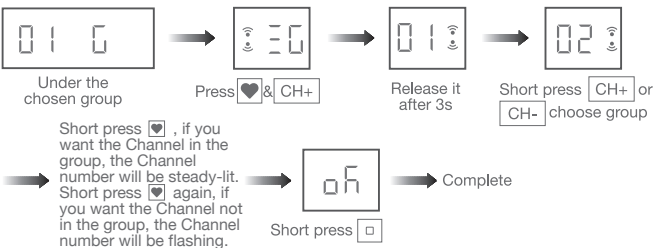

e.Check the Channels in Groups

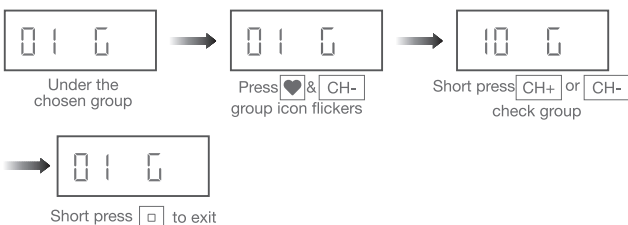

f.Prohibit Dual-key Operation

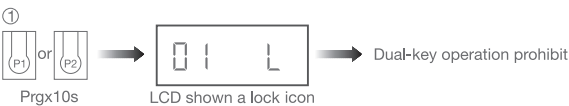

② Repeat the above, dual-key operation activated

Note: When dual-key operation prohibited, these programming setting functions are not allowed.

g.Position Percent Setting

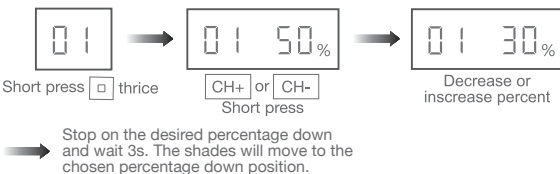

Note: All the shades under same group will run to same position after percent setting.

h.For other operations, please refer to the motor operation instruction

06 FCC Compliance

This device complies with part 15 of the FCC Rules. Operation is subject to the following two conditions: (1) This device may not cause harmful interference, and (2) this device must accept any interference received, including interference that may cause undesired operation.

Any Changes or modifications not expressly approved by the party responsible for compliance could void the user's authority to operate the equipment.

This equipment has been tested and found to comply with the limits for a Class B digital device, pursuant to Part 15 of the FCC Rules. These limits are designed to provide reasonable protection against harmful interference in a residential installation. This equipment generates, uses and can radiate radio frequency energy and, if not installed and used in accordance with the instructions, may cause harmful interference to radio communications. However, there is no guarantee that interference will not occur in a particular installation. If this equipment does cause harmful interference to radio or television reception, which can be determined by turning the equipment off and on, the user is encouraged to try to correct the interference by one or more of the following measures:

Reorient or relocate the receiving antenna.

Increase the separation between the equipment and receiver.

Connect the equipment into an outlet on a circuit different from that to which the receiver is connected.

Consult the dealer or an experienced radio/TV technician for help.

Please take attention that changes or modification not expressly approved by the party responsible for compliance could void the user's authority to operate the equipment.