

Quick User Guide

General Information

The PROWLTOUCH is a wireless Touchscreen that allows you to perform security and automation functions, as well as to monitor the status of your security system.

Navigating Menus

System Status is displayed on the left side of the screen and the time and date are displayed at the top-right of the Security Screen. The Security Screen displays the system status and selection “icons”. The displayed pages and options may vary slightly depending upon the devices and services that are installed in or connected to the system.

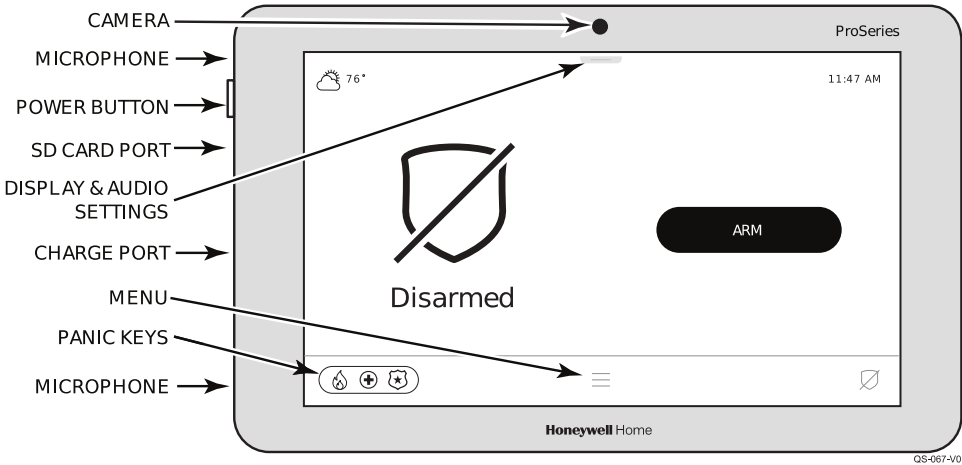

PROWLTOUCH Wireless Touchscreen

Arm the System

Steps	Icons	Commands
1		If the system is “Ready to Arm”, touch the button.
2		Select when you're away from home
	OR	
		Select when you'll be home, and all motion detectors are not armed
	OR	
		Select when you'll be home at night, but certain motion detectors will be armed.
3		Enter user code. <ul style="list-style-type: none">System arms in selected modeExit Delay countdown beginsKeypad beeps begin, if enabled (Silent Exit mutes countdown beeps)Keypad will not display if your installer has “Quick Arm” feature enabled in the system.

Panic Alarms

See your installer for types of Panic alarms programmed for your system.

Steps	Icons	Commands
1		Select the Panic icon in the bottom-left of most screens
2		Select the Fire icon to alert the monitoring company that a fire condition exists. (Displays zone 995) OR
		Select the Police icon to alert the monitoring company that a police emergency exists. (Displays zone 999, default is silent) OR
		Select the Medical icon to alert the monitoring company to other types of emergency. (Displays zone 996)

Assign User Codes

Steps	Icons	Commands
1		Select the Menu icon.
2		Scroll down and select Settings icon.
3	User Management	Select “User Management”
4		Enter the current Master or Partition Master Code. The default Master Code is 1234.
5		Select the “+” icon in the top-right of the screen
6	Name Label	Enter the user’s name and select “SAVE”.
7		Select the Pencil icon to the right of the “Pin” box. Then, enter the 4-digit user code for the new user.
8	Partition Access / Authority Level	Select the down arrow to the right of each partition to give the user an Authority Level for that partition. <ul style="list-style-type: none">None – User will not work in partitionUser – User can arm, disarm, and bypass in partitionGuest – User can disarm only if it was used to armArm Only – User can arm only and cannot disarmPartition Master – Same as Master code, but cannot change the Master codeDuress – Wil send a Duress signal to the Central Monitoring center when used to disarm the system.
9	Bluetooth (OPTIONAL)	Select “Bluetooth Disarming” to pair the user’s Bluetooth device. This will allow automatic disarming of the system when the user’s Bluetooth device is within range.
10		Once complete, select .
11		Enter the current Master or Partition Master Code. The default Master Code is 1234. The new user is displayed on the list.

Bypassing Zones

Steps	Icons	Commands
1		Select .
2		Enter the 4-digit code.
3		Select , then, select your arming mode; AWAY, HOME, or NIGHT.
OR		
1		If “Force Bypass” feature is enabled by your installer, select to automatically bypass all faulted zones, then select your arming mode; AWAY, HOME, or NIGHT
OR		
1		Select to display a list of faulted zones. Select each zone to bypass by touching the box to the far right of each zone.
2		Select .
3		Enter your 4-digit user code.
4		Select the back “<” icon.
5		Select , then select your arming mode; AWAY, HOME or NIGHT.

Menu

Icon	Name	Options
	Menu	Select the Menu icon to access the list of options below.
	Favorites	Future Use.
	Devices	Provides access to Z-Wave Devices and Z-Wave Management
	Sensors	Provides access to Zone information and options
	Cameras	Provides access to cameras
	Scenes	Provides access to Scenes for Z-Wave Automation programming.
	Events	Provides access to system Activity Log.
	Settings	Provides access to Wi-Fi settings, User Management, and Voice Services (Amazon Alexa)
	Tools	Provides access to System Info (Version, MAC and ID’s), System Tests (Communicator and Sensors), and System Reboot

Test the System

Disarm the system and close all zones so the system is “Ready to Arm”.

NOTE: These tests will not generate alarm messages. No alarm signals are sent to your monitoring company.

Steps	Icons	Commands
1		Select the Menu icon. Scroll up or down through the menu options.
2		Scroll down and select the “Tools” icon. Then, enter the Master code.
4	System Tests	Select “Test Communicator” or “Test Sensors”
5A	Test Communicator	This will give you the option to select “Test Wi-Fi”, “Test Cellular” or “Test Both”. The system will display test results.
5B	Sensor Test	Select “Test Sensors”. You will see a list of sensors programmed in your system.
5B		Select . The system’s sounder will sound for a half second.
5B	Fault Sensors	Activate each zone. The system will provide chime beeps and annunciate each zone along with displaying the signal and battery levels.
6		When testing is complete, select .

