

PINEWORLD

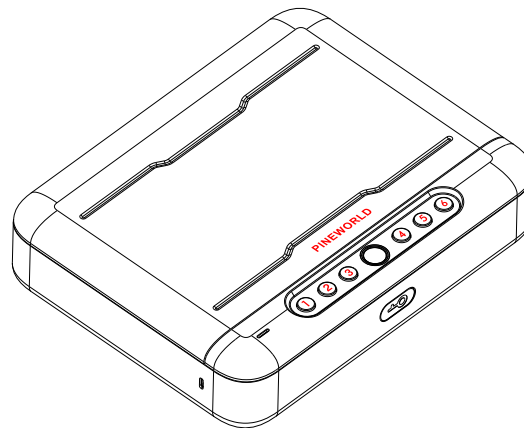

K3 Biometric Smart Safe User Manual



CP65

Jiangxi Fingerchip Intelligent Technology Co.,Ltd
No.133 Yishang Avenue, Economic Development Zone, Yichun City,
Jiangxi Province, China
<https://www.pineworld.net>
support@fingercrystal.com.

Please read this instruction carefully before using the product.

Jiangxi Fingerchip Intelligent Technology Co.,Ltd. reserves the final right to interpret this manual.

V1.1

Contents

Notice-----	2
Introduction-----	3
User Guide-----	4
Fixation Instructions-----	8
FAQ-----	9

What's In The Box

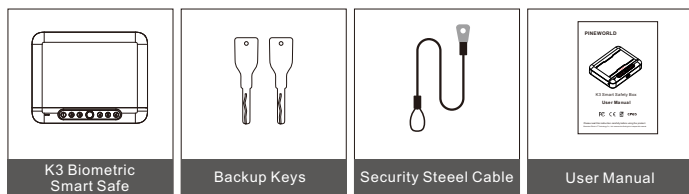

Quick Start Guide

Initial Password: 123456

Add Administrator/User: Long Press 6

Mute Mode: Long Press 2

Fast Pairing: Long Press 3

Remotely Unlock: Long Press 4

1.Notice

Thanks for using PINEWORLD K3 Smart Gun Safe.To bring you a better experience, please read the User Manual first.



A. If it is the first time unpack the box, please use the backup key to unlock it.



B. Please change the original passcode as soon as possible and do not disclose the passcode.



C. About emergency charging:

- ① The power supply port only supports emergency power supply and does not support long-term power supply.
- ② **The product is not equipped with charging cable.** If necessary, please prepare a charging cable (5V-2A Max) at home to unlock it in an emergency.
- ③ In order not to affect your further use, please replace the battery timely after emergency unlocking,



D. Keep your fingers clean when using the fingerprint to unlock.



E. The acceptable operating temperature for the product ranges from -25°C to 55°C.



F. Do not use corrosive materials to clean the device. Otherwise, the protective coat of the device may be damaged.



G. Neither keep the battery near the fire source nor use metal objects to connect the two poles of the battery, which will incur short-circuit of the battery and even explosion.

2.Introduction

The product is a smart safety box that supports multiple unlocking ways, including fingerprint, passcode, Bluetooth, remote unlocking and backup key unlocking. With the unlocking speed of 0.5s, it helps you quickly take out your items; multiple intelligent alarms such as trial-and-error alarm, tamper alarm, coercive alarm, and low power alarm bring you more smart experience; multiple anti-theft designs including steel cable, fixed hole, C-level key cylinder and alarm can effectively prevent thieves from destroying the equipment and safeguard the product. Furthermore, the device has been connected to the FC Smarthome APP, which enable you to experience the scientific and technological charm of intelligent management and control.

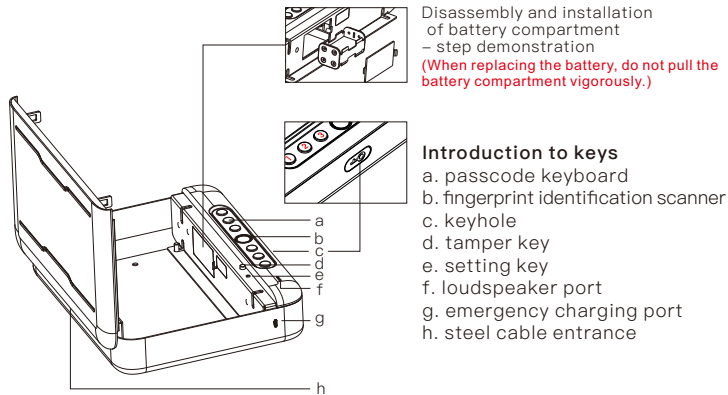

Specification

Color	Black
Size	285mm*225mm*65mm
Weight	7.7lbs
Unlocking ways	Fingerprint, Passcode, APP unlocking, Backup key
Fingerprint resolution	500DPI
Capacity	Fingerprint: 50, Passcode: 50
Type-C Input Power	5V-2A(Max)

3.User Guide

A. Install the battery

- ① Please use the backup key to unlock and open the battery compartment cover;
- ② Gently unplug the battery compartment and put in four new AA batteries of the same brand
(Note: do not pull the battery compartment vigorously.)
- ③ Put the battery compartment and connecting wire into the trough.

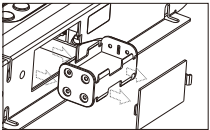
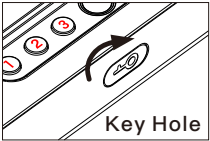

B. Add the administrator

Press and hold the key No. 6 and add administrators according to the voice prompt. (The first two are for administrators, and the first one must be in the form of passcode, and the second one can be fingerprint or passcode.)

Note:

- ① Passcodes setting: a 6-digit passcode must be set. The passcode entered should not be too simple. (e.g. 123456)
- ② Fingerprints setting: you are required to press the same finger 6 times. To improve the fingerprint recognition rate, it is recommended to press the same finger at different angles and locations. Do not change your fingers during the fingerprint recording.

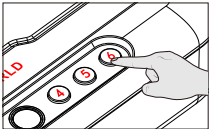

C. Bind mobile phones to the device

- ① Scan the QR code to download the Smart APP (FC Smarthome);
- ② Open the APP and select manually add – smart safety box – K3. Operate according to the prompts of the APP (Only 2.4Ghz WiFi is supported, and the distance between the router and the device should not exceed 15m.);
- ③ The binding is successful.



APP Download QR Code

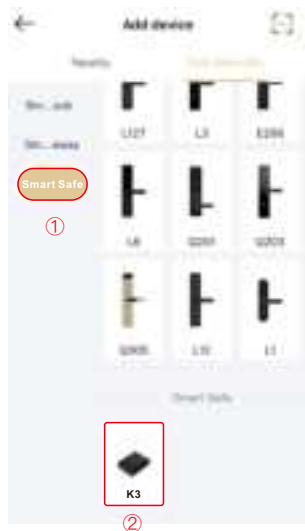
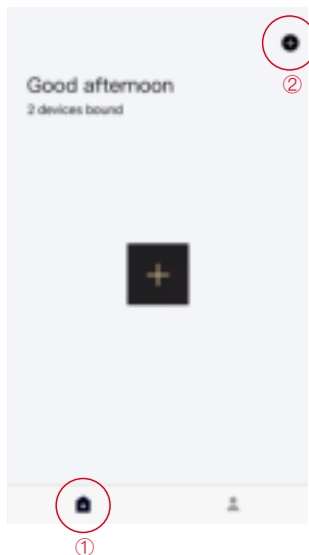

D. Other operations

Local shortcut keys:

- ① **Check the version:** hold down key No.1
- ② **Mute mode:** hold down Key No. 2 to support mute/unmute adjustment.
- ③ **Fast pairing:** hold down Key No. 3 to bind in the smart APP (FC Smarthome).
- ④ **Remotely unlock:** hold down Key No. 4 (used only when paired).
- ⑤ **Change the passcode:** hold down Key No.5 (Only support the passcode change.).
- ⑥ **Add users:** hold down Key No. 6.
- ⑦ **Delete users:** hold down Key No. 6, and after verifying the administrator hold down 6 again.
- ⑧ **Factory Reset:** long-press setting button for 3 seconds (need to verify administrator)



Local alarm and others:

- ① **Coercive alarm:** when the passcode or fingerprint dedicated to the coercive alarm is used to unlock the device, the message receiver will be informed of the danger encountered by the user, and the information will be reported in the APP. (Setting path: APP setting – coercive setting – coercive object and acceptor setting – successful saving)
- ② **Prying-resistant alarm:** When the device is damaged and the anti-disassembly key is loose, the alarm will be triggered to sound as long as 180s and the information will be reported in the APP.
- ③ **Low voltage warning:** when the power is low, the warning message will be broadcast. Please replace the battery in time.
- ④ **Alarm clearing method:** verify the registered passcode or fingerprint to clear alarms.

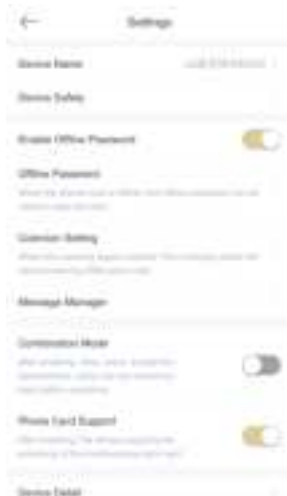

Card



4.Fixation Instructions

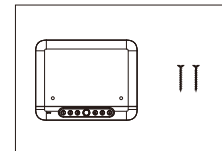
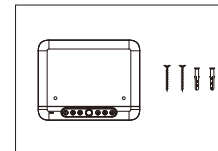
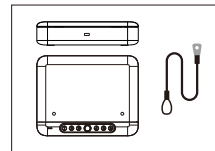

- ① Vehicle seat: use steel security cable (bind it with the seat).
- ② Wooden material: use fixed holes.
- ③ Concrete, metal, stone materials: use fixed hole (please use expansion screws + self-tapping screws).

Material at the fixation place	Installation suggestions	Fitting size suggested
Random	Use steel security cable to fix	Standard
Wooden material	Use fixed holes	self-tapping screws M5*25mm (self-driving screws #10*1 inch)
Concrete, metal, stone materials	Use fixed holes	Plastic Expansion Pipe, 6*40mm +self-tapping screws M4*25mm (self-driving screws #8*1 inch)

The above information is for reference only. All depend on the actual situation.

5.FAQ

⑨ How to use after unpacking?

When it is the first time to unpack, please use the backup key to unlock the safe. Open the battery compartment and put in four new batteries of the same brand, and long press Key No. 6 to set the administrator.

⑩ Can it always be charged with the emergency type-C port?

No, the power supply port only supports emergency power supply. Long connection of power supply will affect the service life of the product. (The product is not equipped with charging cable)

⑪ Why I failed to add the fingerprint/passcode?

Fingerprint recording: a. please ensure that the same finger is recorded in each group; b. recommend to record the same finger from multiple angles and edges.

Passcode recording: do not set too simple passcode. (Example: 123456)

⑫ What should be noted at the fingerprint and passcode identification?

Fingerprint identification: a. please ensure that your finger is dry and without stains; b. please ensure that the position of the verified finger is consistent with the input one.

Passcode identification: ensure that the entered passcode correct.

⑬ How to confirm or return?

When verifying passcode, you enter a passcode of 6 digits, the system will automatically confirm the passcode, and if no operation status lasts for 7 seconds, it will return due to overtime. During setting, press the key as prompted to automatically confirm the setting. If no operation status lasts for 7 seconds, it will return due to overtime.

⑭ When the equipment is running out power, how to turn it on for emergency?

You can enter the registered passcode or fingerprint to unlock the device through the emergency charging port on the left side of the device (5V-1A), or directly use the backup key to unlock the device. (Note: The product is not equipped with the type-c cable.)

⑮ What should be noted when replacing the battery?

When the device prompts the warning of low battery, please replace four new batteries of the same brand in time. (Note: the service life will be affected if old and new batteries are mixed to use.)

⑯ What should I do when forgetting the administrator passcode?

You can log in the FC Smarthome APP to update the administrator's passcode from the 'management passcodes', or briefly describe the problem you encountered and send it to our official email: support@fingercrystal.com.

⑰ How to remove the alarm when the device always alarms or being indicated that the system is locked?

Enter the registered passcode or fingerprint once.

⑱ What should I do when the cover of the safe cannot be closed properly?

You can open the cover again or check whether the opening place is stuck or not. If the fault still cannot be solved, please briefly describe the problem you encountered and send it to our official email: support@fingercrystal.com.

⑲ What if the recommended fixing screws is unsuitable?

The size suggested above is for reference only. All depend on the actual situation.

⑳ What to do if the device occurs sudden problems that affect its normal operation?

Please briefly describe your problem and send it to our official email: support@fingercrystal.com.

This device complies with Part 15 of the FCC Rules. Operation is subject to the following two conditions: (1) this device may not cause harmful interference, and (2) this device must accept any interference received, including interference that may cause undesired operation.

Changes or modifications to this unit not expressly approved by the party responsible for compliance could void the user's authority to operate the equipment.

NOTE: This equipment has been tested and found to comply with the limits for a Class B digital device, pursuant to Part 15 of the FCC Rules. These limits are designed to provide reasonable protection against harmful interference in a residential installation. This equipment generates, uses and can radiate radio frequency energy and, if not installed and used in accordance with the instructions, may cause harmful interference to radio communications. However, there is no guarantee that interference will not occur in a particular installation. If this equipment does cause harmful interference to radio or television reception, which can be determined by turning the equipment off and on, the user is encouraged to try to correct the interference by one or more of the following measures:

- Reorient or relocate the receiving antenna.
- Increase the separation between the equipment and receiver.
- Connect the equipment into an outlet on a circuit different from that to which the receiver is connected.
- Consult the dealer or an experienced radio/TV technician for help.

This device and its antenna(s) must not be co-located or operation in conjunction with any other antenna or transmitter.

Radiation Exposure Statement

To maintain compliance with FCC's RF Exposure guidelines, This equipment should be installed and operated with minimum distance of 20cm from your body.